

# BAC 1-11-500 'SUPER ONE-ELEVEN'

DAN-AIR, NATIONWIDE, TRANS BRASIL

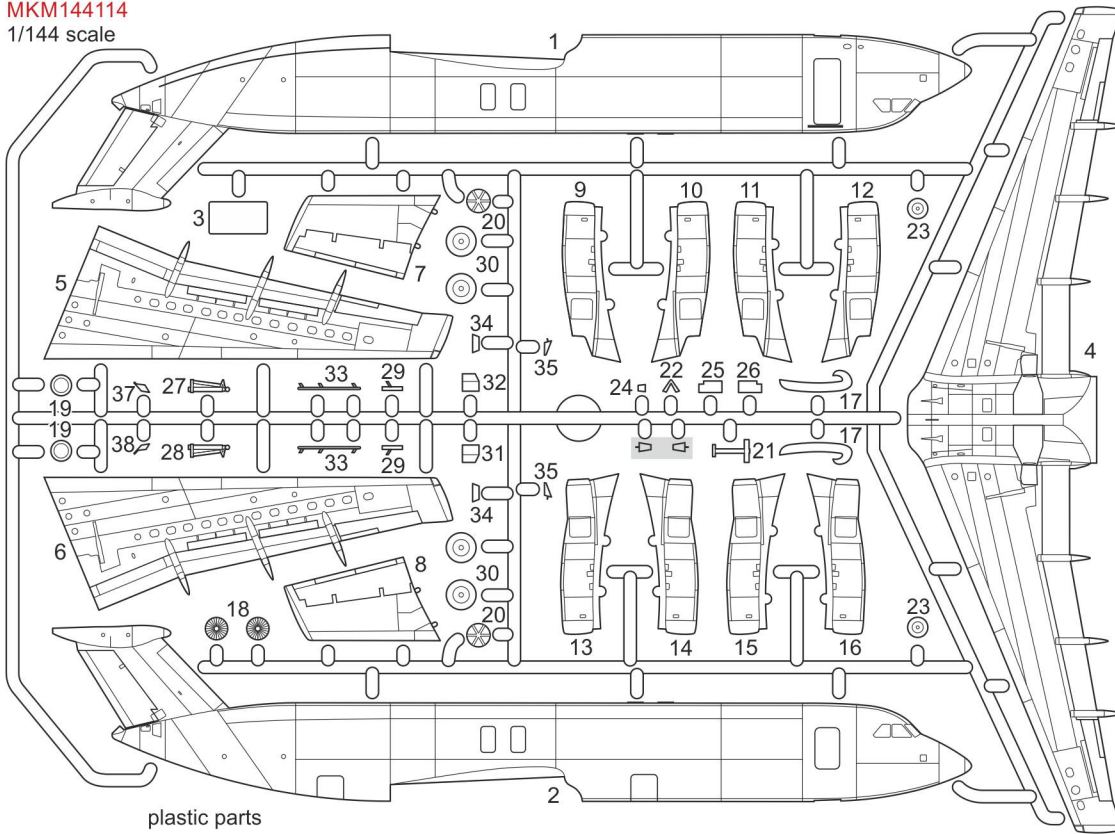

MKM144114  
1/144 scale



MARK I Ltd.  
PO Box 10  
Prague 10 - Strašnice  
CZ-100 31  
Czech Republic  
mark1@gmail.cz  
www.4pluspublications.com

parts not  
to be used

display base

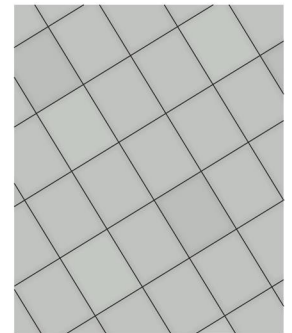

- Repeat this operation
- Glue
- Don't glue
- Decal
- Detach/cut
- Bend
- Drill
- Optional

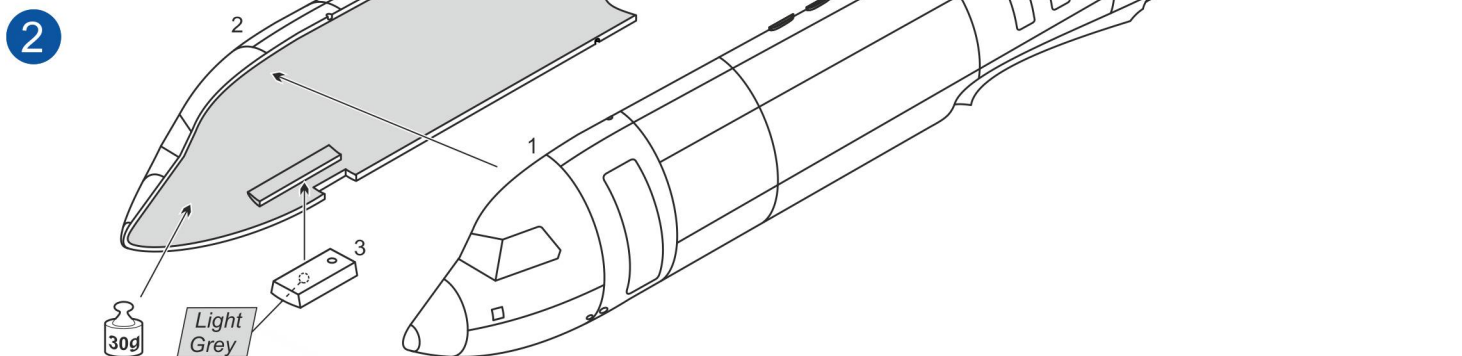
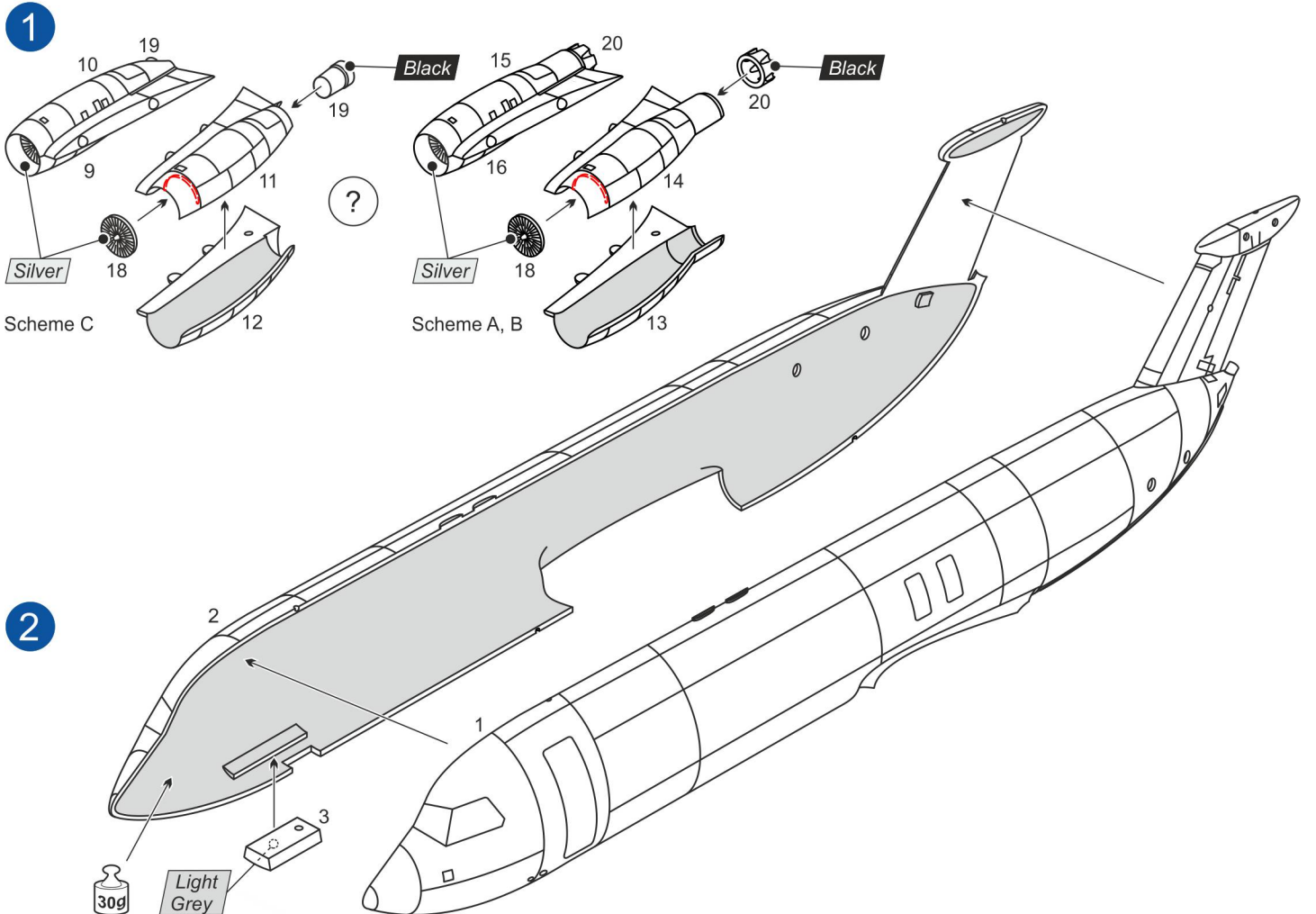

3

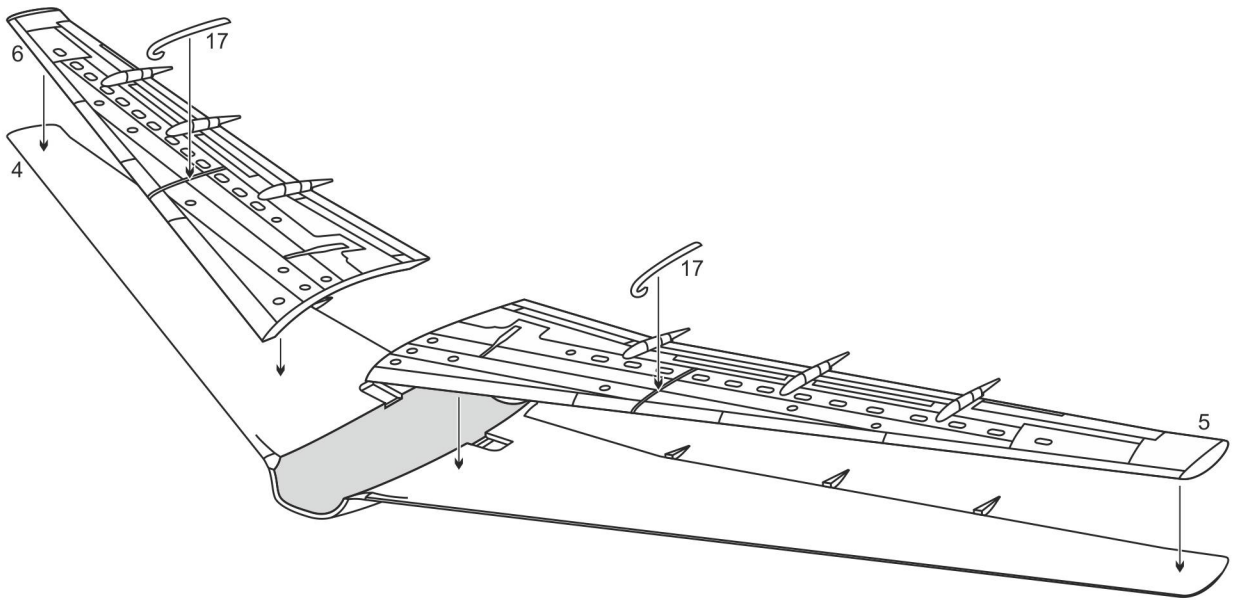

4

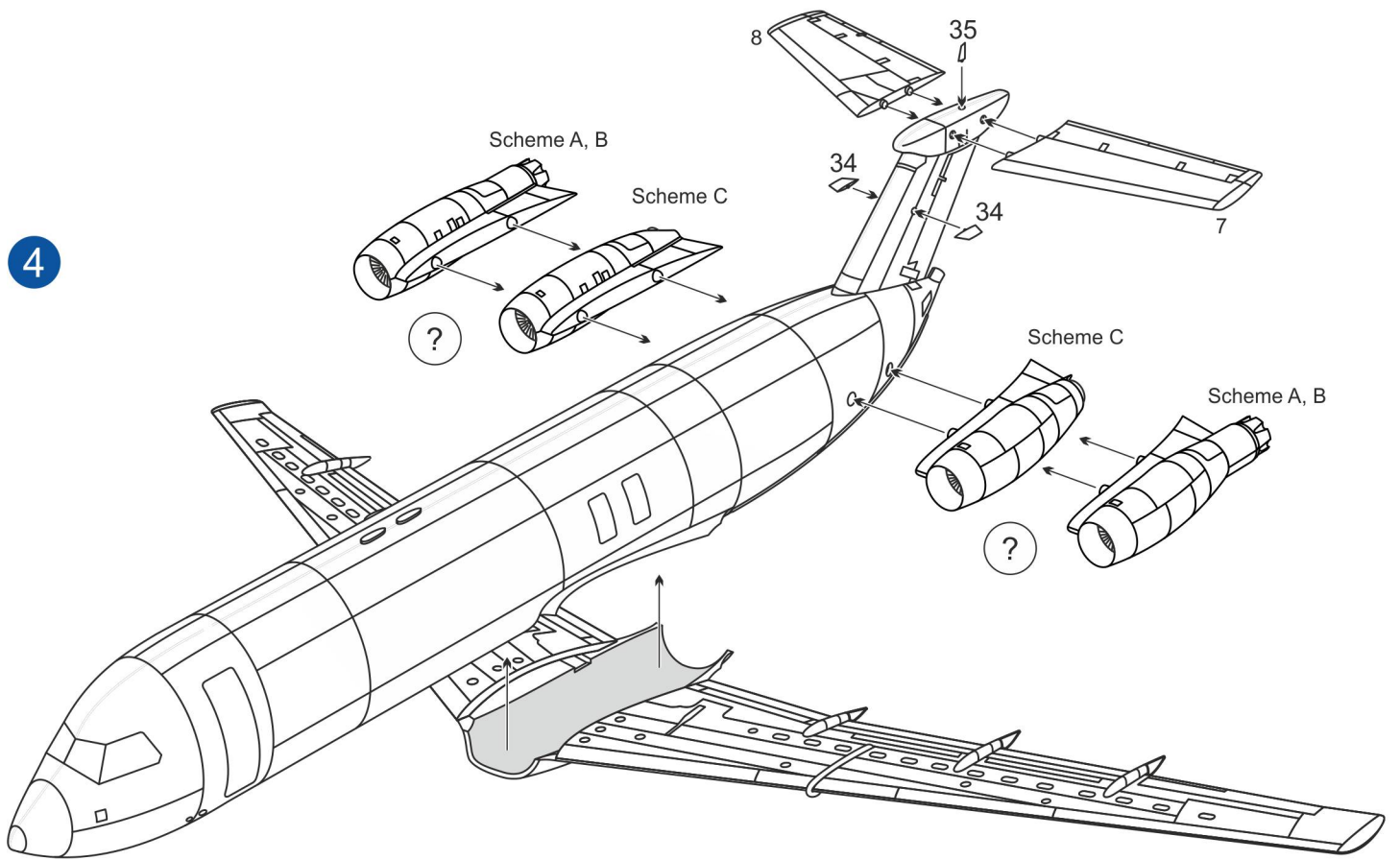

Front view

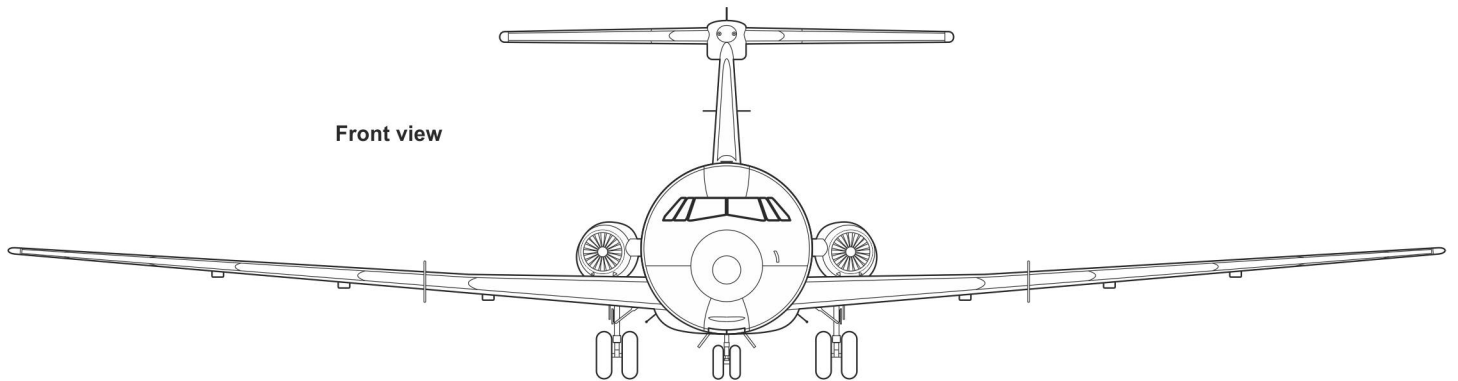

5

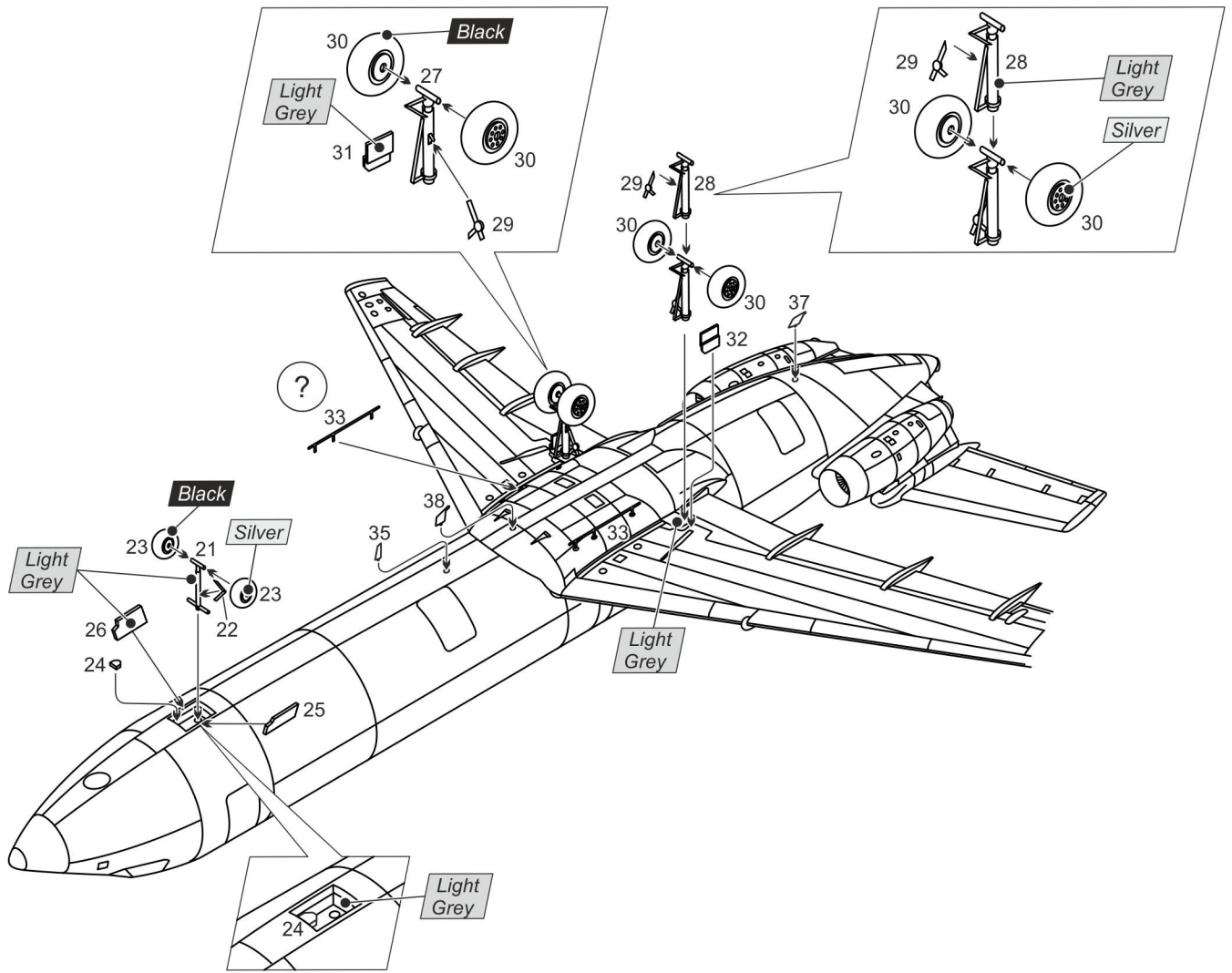

**A** British Aircraft Corporation BAC 1-11-500 (525FT), G-TARO (ex-YR-BCO, c/n 272), Dan Air Services Ltd. (Dan-Air London, a/c leased from Taron), Gatwick Airport, West Sussex, U.K., 1984-85

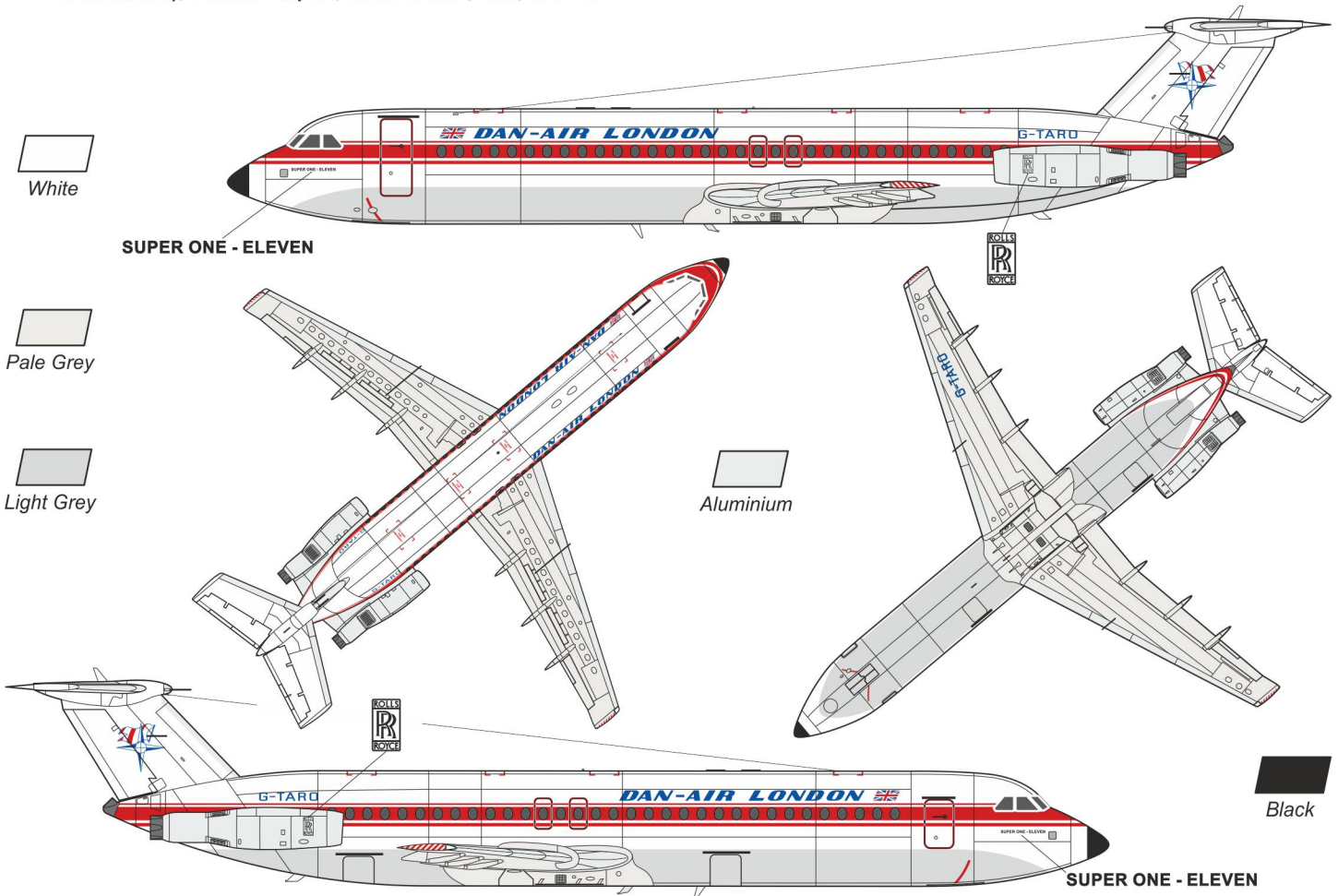

**B** British Aircraft Corporation BAC 1-11-500 (531FS), ZS-NUG (c/n 237), Nationwide Airlines (Pty) Ltd., Johannesburg Intl. Airport, Gauteng, South Africa, 1995-2000

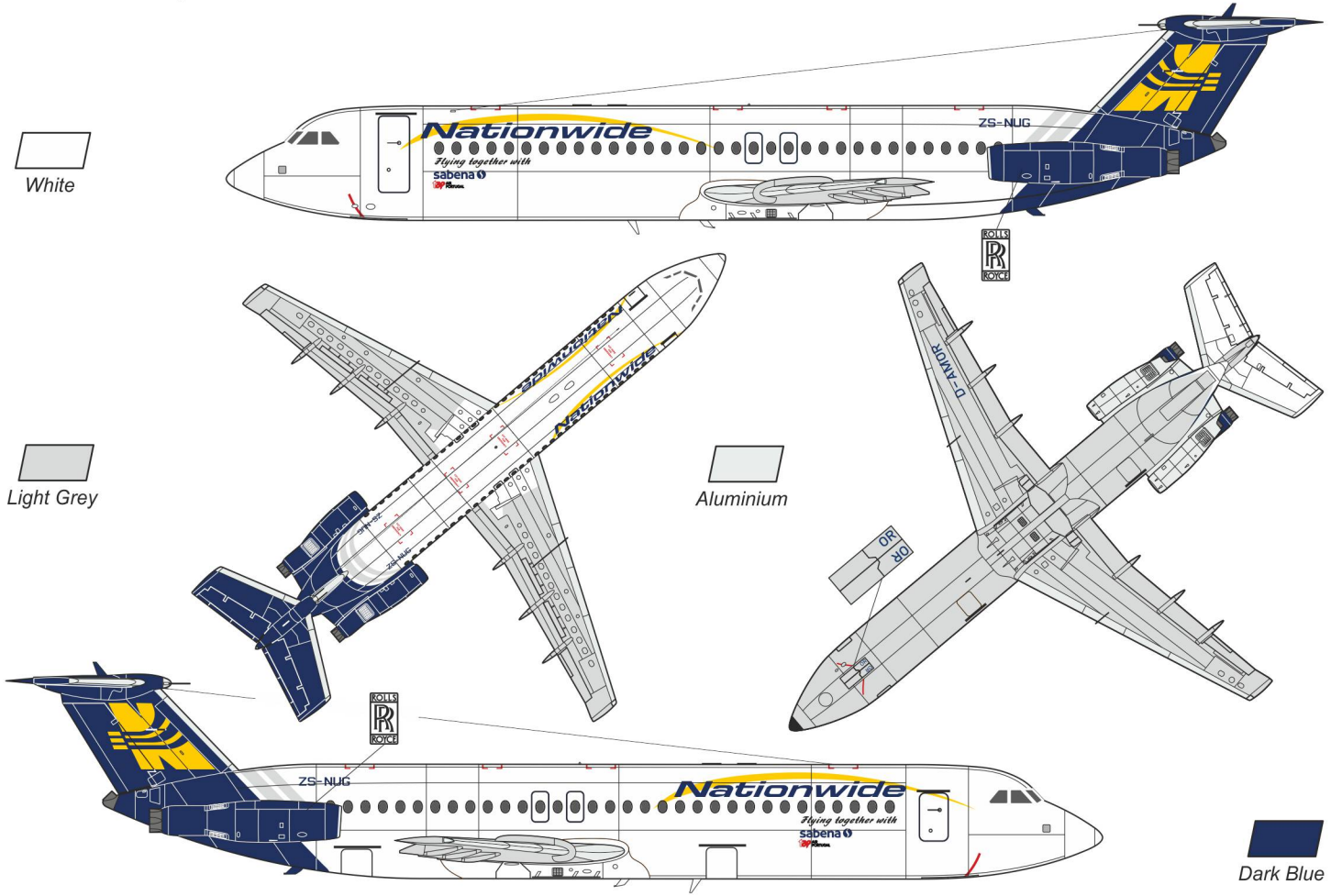

**C** British Aircraft Corporation BAC 1-11-500 (520FN), PP-SDS (c/n 236), Transbrasil S/A Linhas Aéreas, São Paulo/Congonhas Airport, Brazil, 1972-76

