

BAC 1-11-500 'SUPER ONE-ELEVEN'

LONDON EUROPEAN, BAVARIA GERMANAIR, JAT

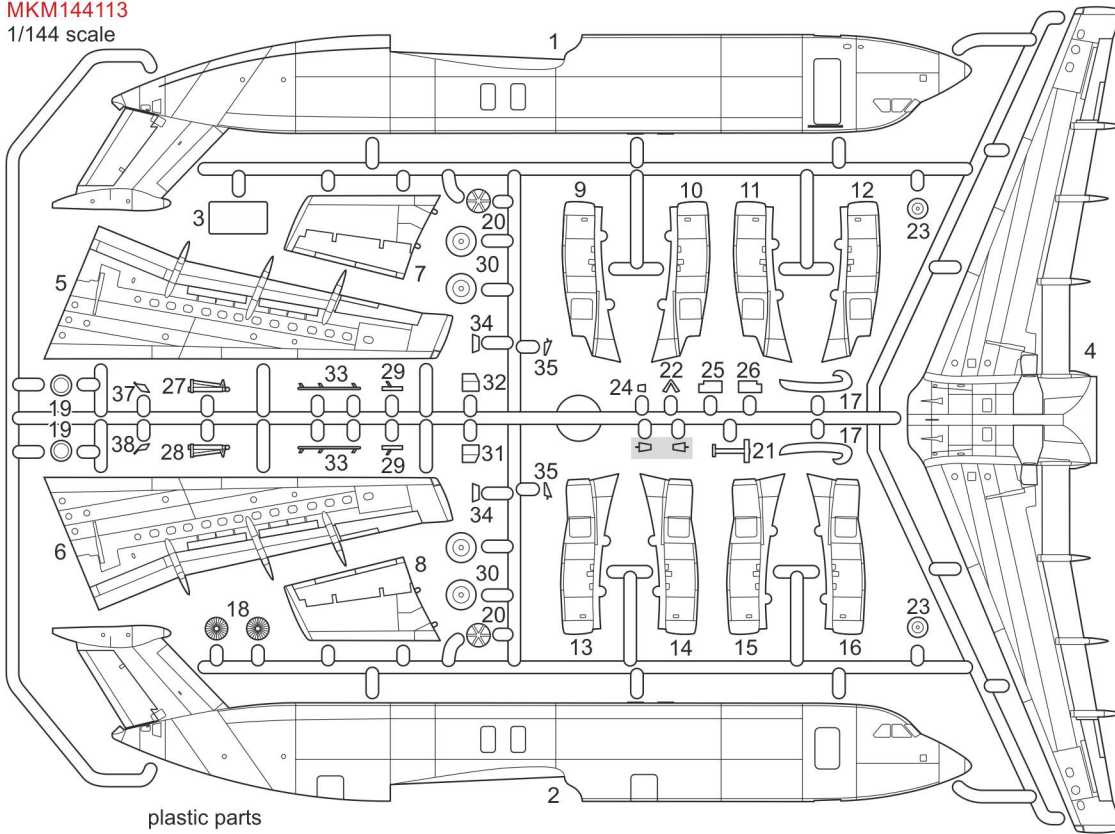

MKM144113
1/144 scale



plastic parts

MARK I Ltd.
PO Box 10
Prague 10 - Strašnice
CZ-100 31
Czech Republic
mark1@gmail.cz
www.4pluspublications.com

parts not to be used

display base

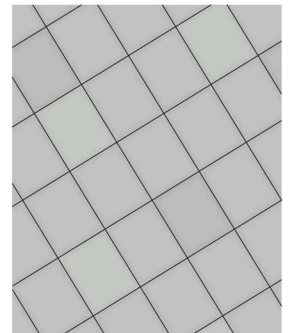

- Repeat this operation
- Glue
- Don't glue
- Decal
- Detach/cut
- Bend
- Drill
- Optional

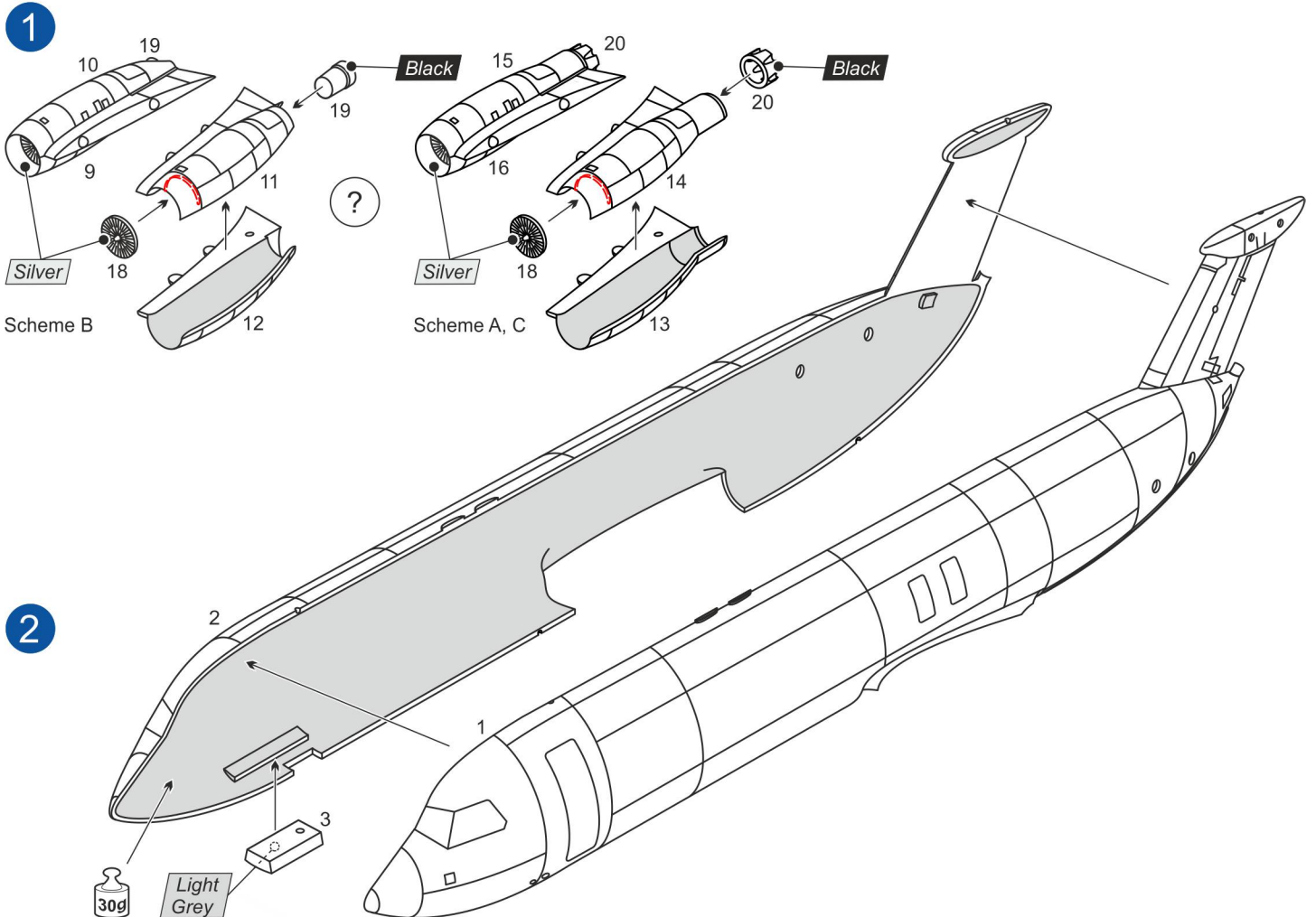

3

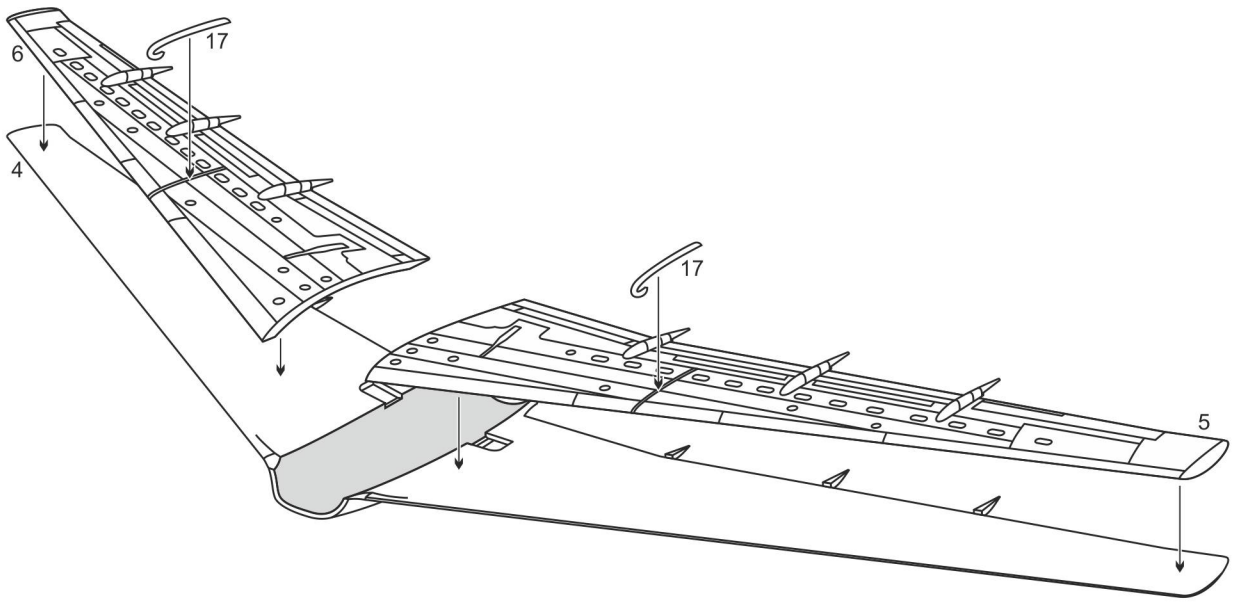

4

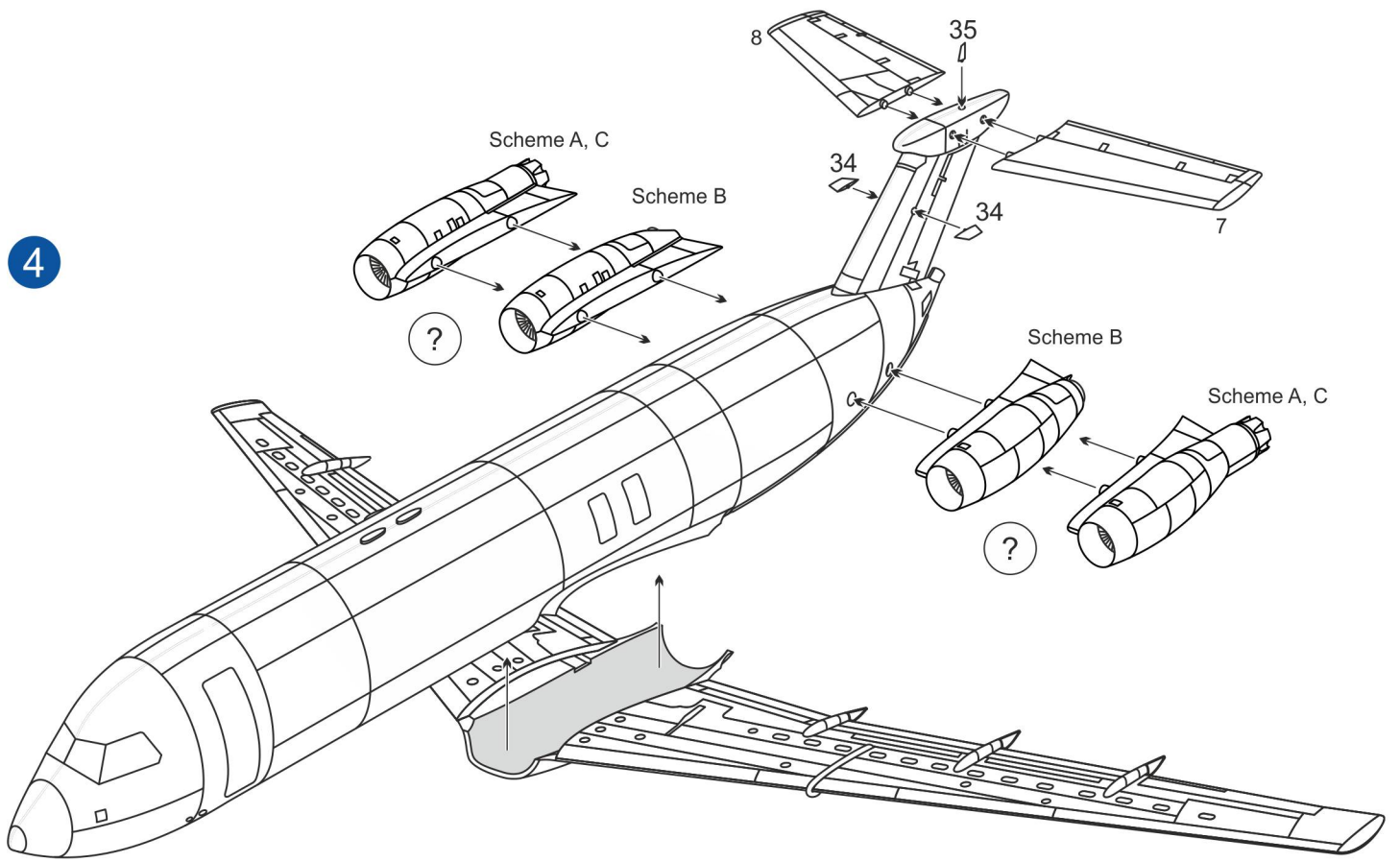

Front view

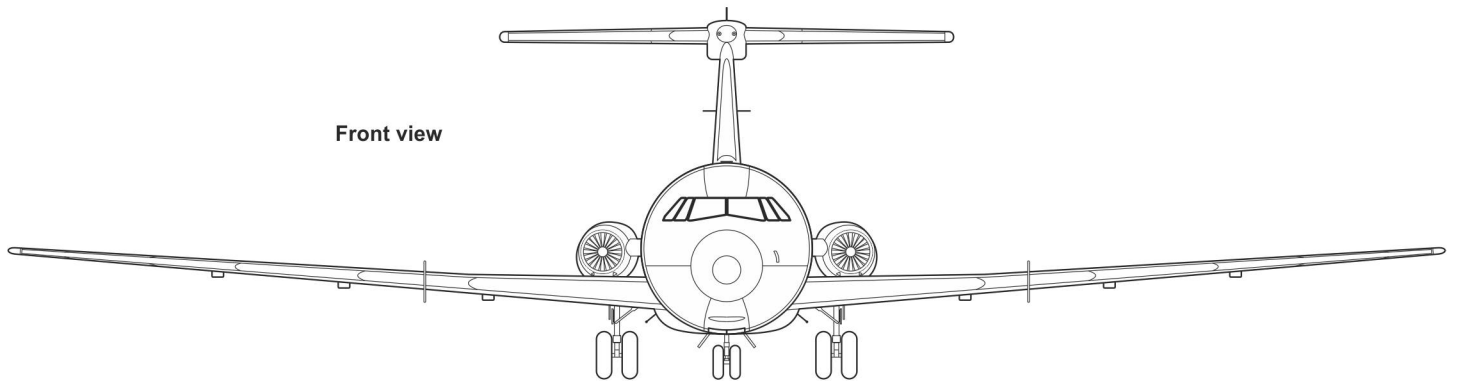

5

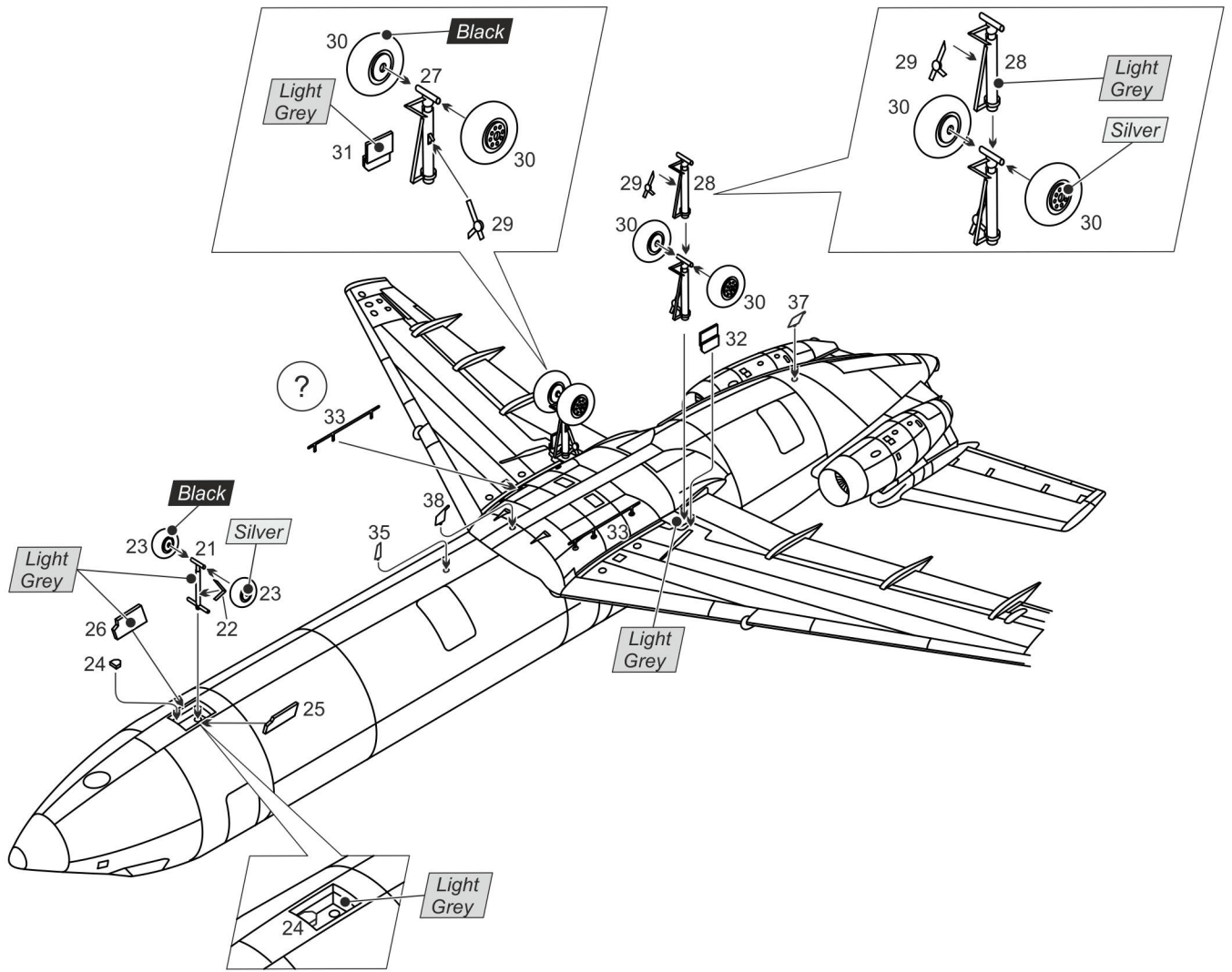

A Rombac (BAC) 1-11-500 (561RC), G-BNIH (ex-YR-BRF, c/n 406), London European Airways Plc. (a/c leased from Tarom), Luton Airport, Bedfordshire, U.K., 1987-90



B British Aircraft Corporation BAC 1-11-500 (524FF), D-AMOR (c/n 197), Bavaria Germanair GmbH, Munich-Riem Airport, Bavaria, West Germany, 1977-78

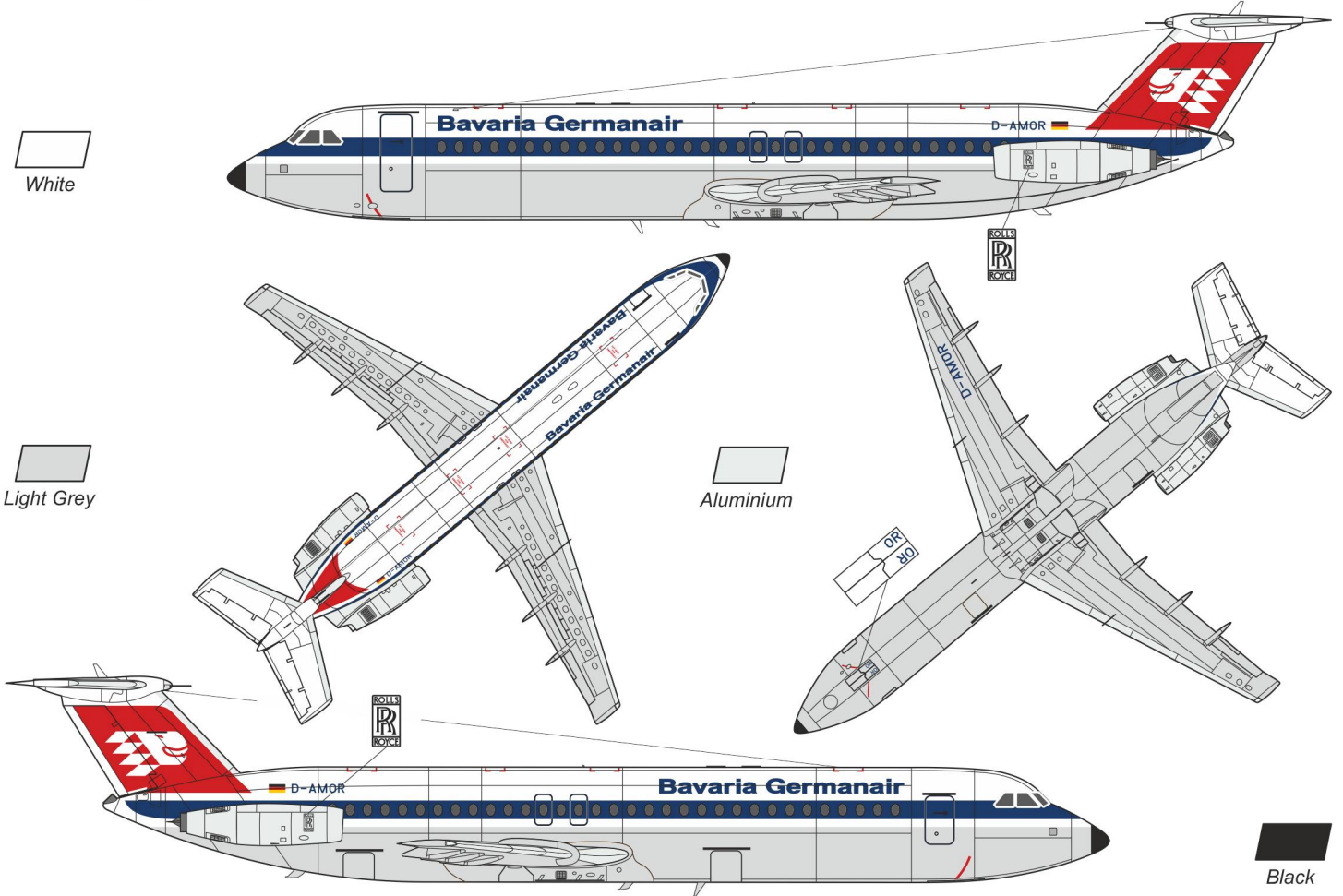

C Rombac (BAC) 1-11-500 (561RC), YR-BRA (c/n 401), JAT Yugoslav Airlines/Jugoslovenski Aerotransport (a/c leased from Tarom), Belgrade Airport, Yugoslavia, 1989

