

Westland Wessex HAS.1

EARLY



MKM144174L
1/144 scale

MARK I Ltd.
PO Box 10
CZ-100 31 Prague 10 - Strašnice
Czech Republic
mark1@cmail.cz
www.4pluspublications.com

20

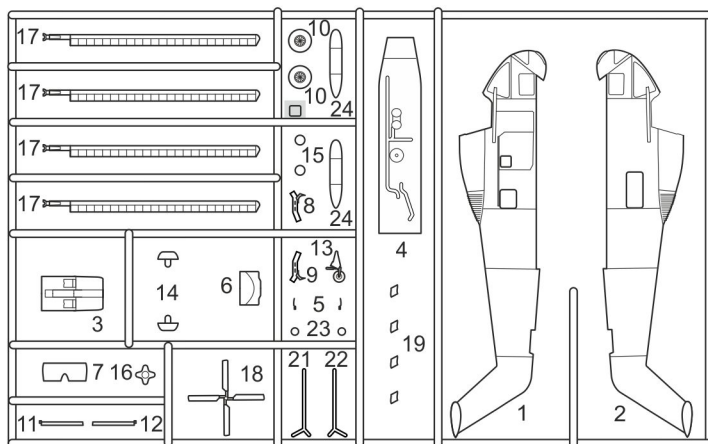

clear parts

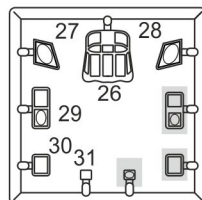

parts not to be used

2x Repeat this operation
 Glue
 Drill
 Detach
 Optional
 Decals

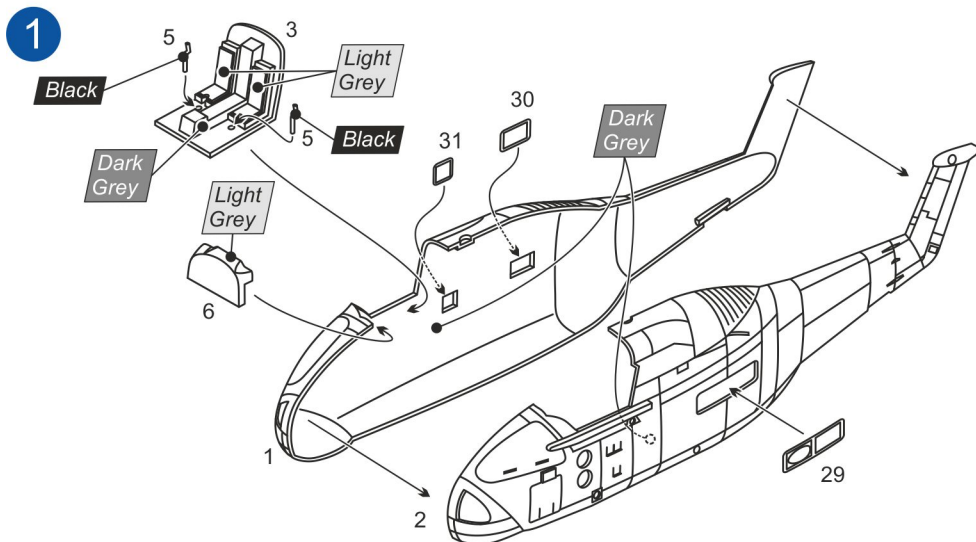

For more information see
4+ Publication "Westland Wessex"

4+ publication



Westland Wessex
HAS.1, HAS.3, HAS.31, HC.2, HAR.2, HCC.4, HU.5, HD.59 G.

*rotary wings
line*
1/12 scale kit

www.4pluspublications.com

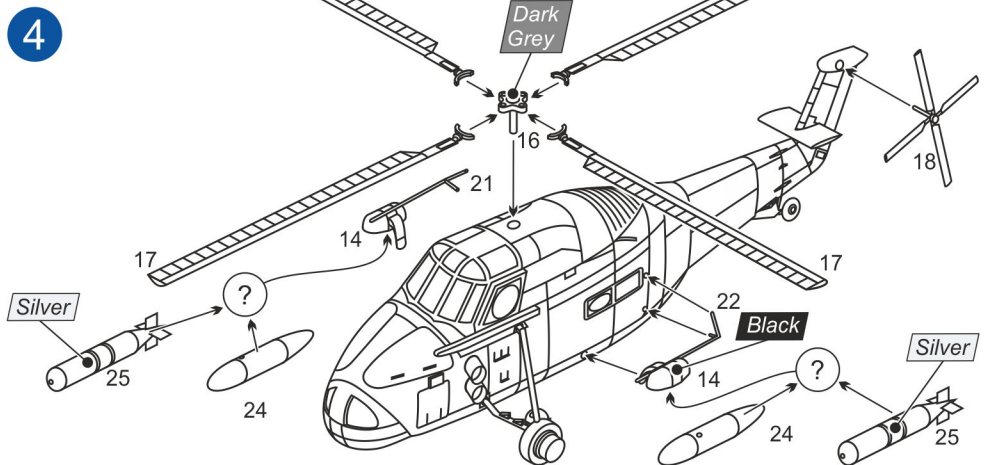
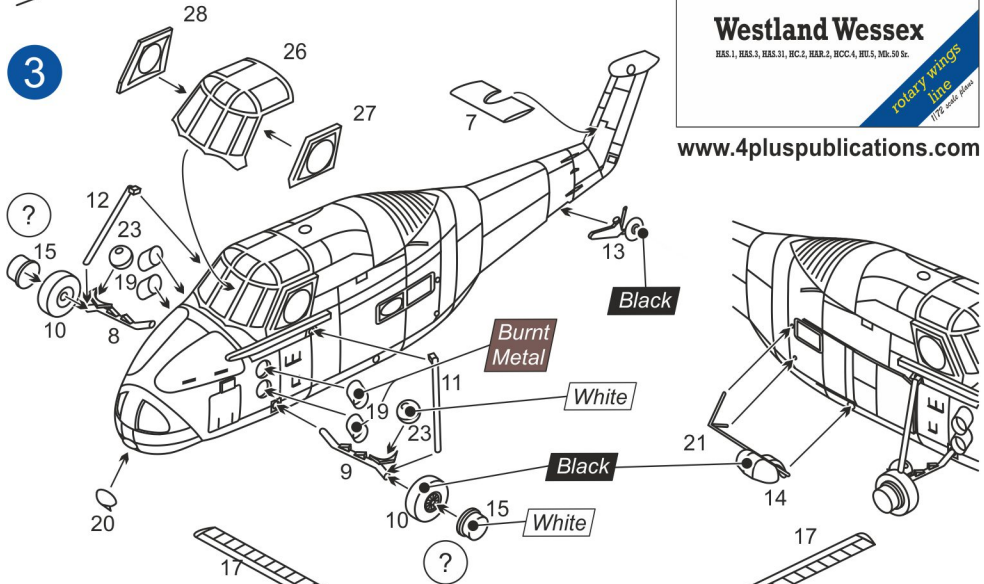
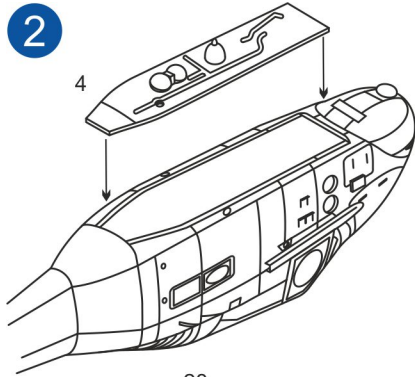

A Westland Wessex HAS.1, XL727 (c/n WA1), Westland Aircraft trials a/c, Yeovil airfield, Somerset, and SBAC Air Show, Farnborough Air Base, Hampshire, U.K., August 1958

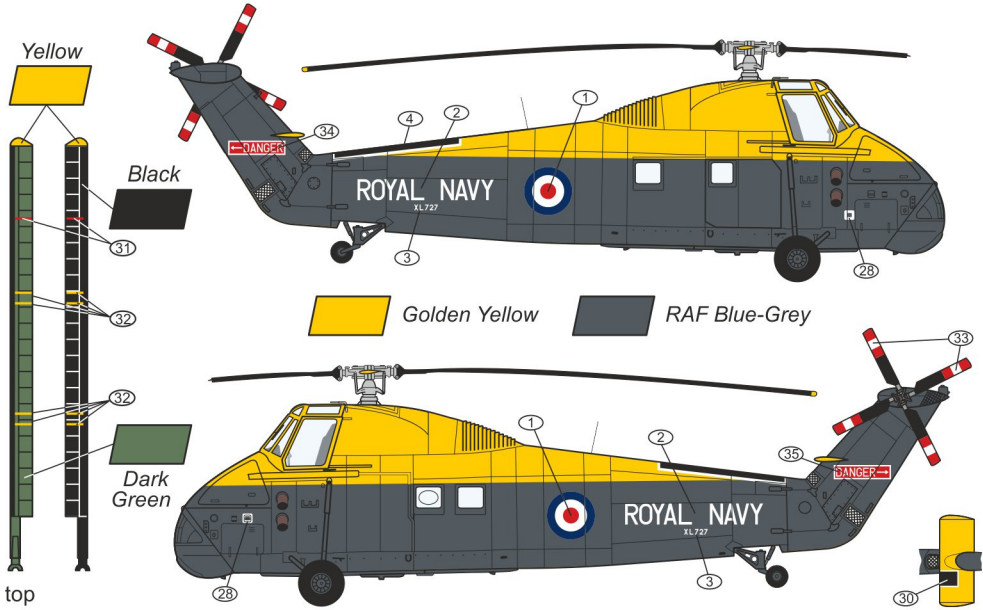

B Westland Wessex HAS.1, XM330 (c/n WA11), trials a/c, Royal Aircraft Establishment (RAE), Ministry of Defence (MoD), Farnborough Air Base, Hampshire, U.K., mod-1970s

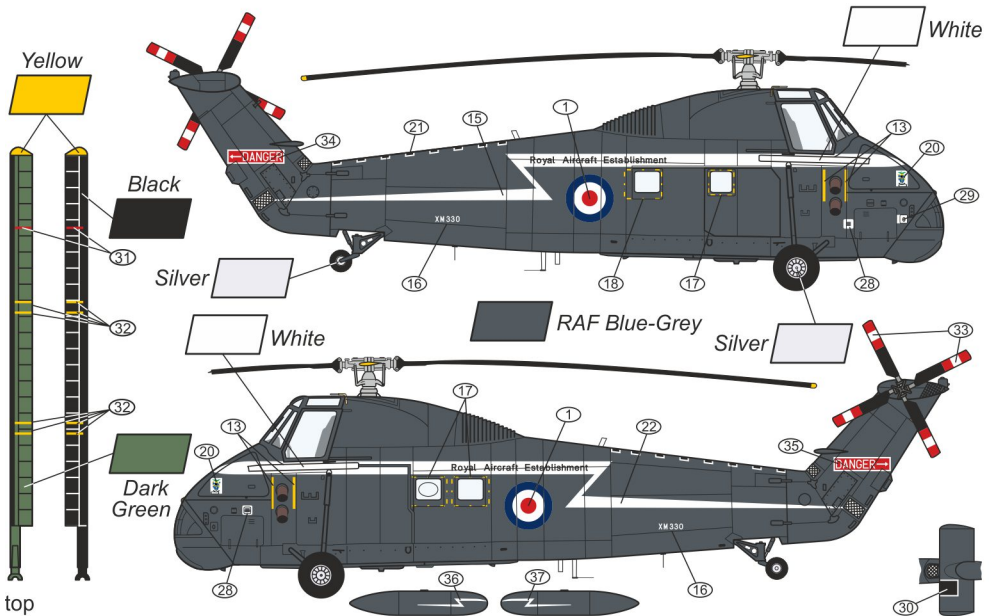



Westland Wessex HAS.1, XM330 (c/n WA11), 'Raspberry Ripple', trials a/c, Royal Aircraft Establishment (RAE), Ministry of Defence (MoD), SBAC Air Show, Farnborough Air Base, Hampshire, U.K., September 1976

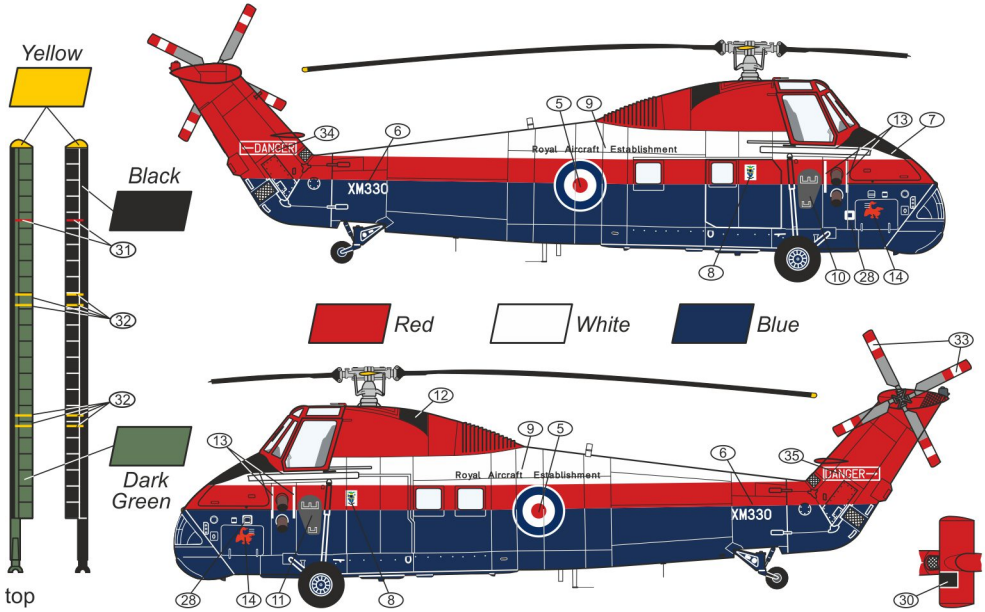

Westland Wessex HAS.1, XM832/506 (c/n WA13), No.700H NAS, Intensive Flying Trials Unit (IFTU), Royal Navy, RNAS Cudrose (HMS Seahawk), Cornwall, U.K., April 1960 - July 1961

