

CMR72-240
1/72 scale

Curtiss A-12 Shrike "Radial Engine"



MARK I Ltd.

PO Box 10
CZ-100 31 Prague 10 - Strašnice
Czech Republic

1 Assembly instructions

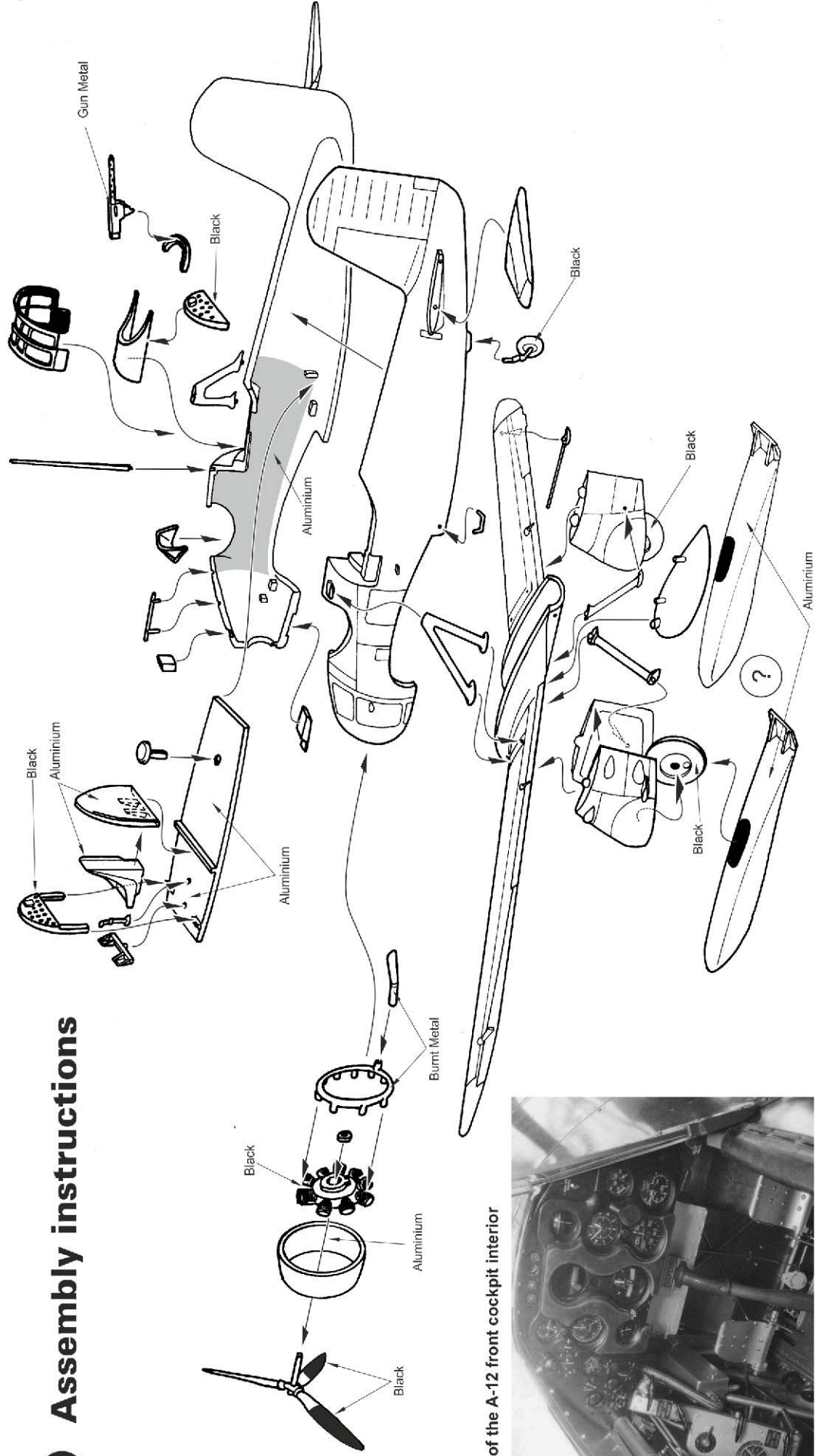

Detail of the A-12 front cockpit interior

2 Camouflage scheme

A Curtiss A-12 Shrike,
serial no.33-217, Black 17,
13th Attack Squadron,
3rd Attack Group,
US Army Air Corps,
Barksdale Field air base,
Louisiana, 1935

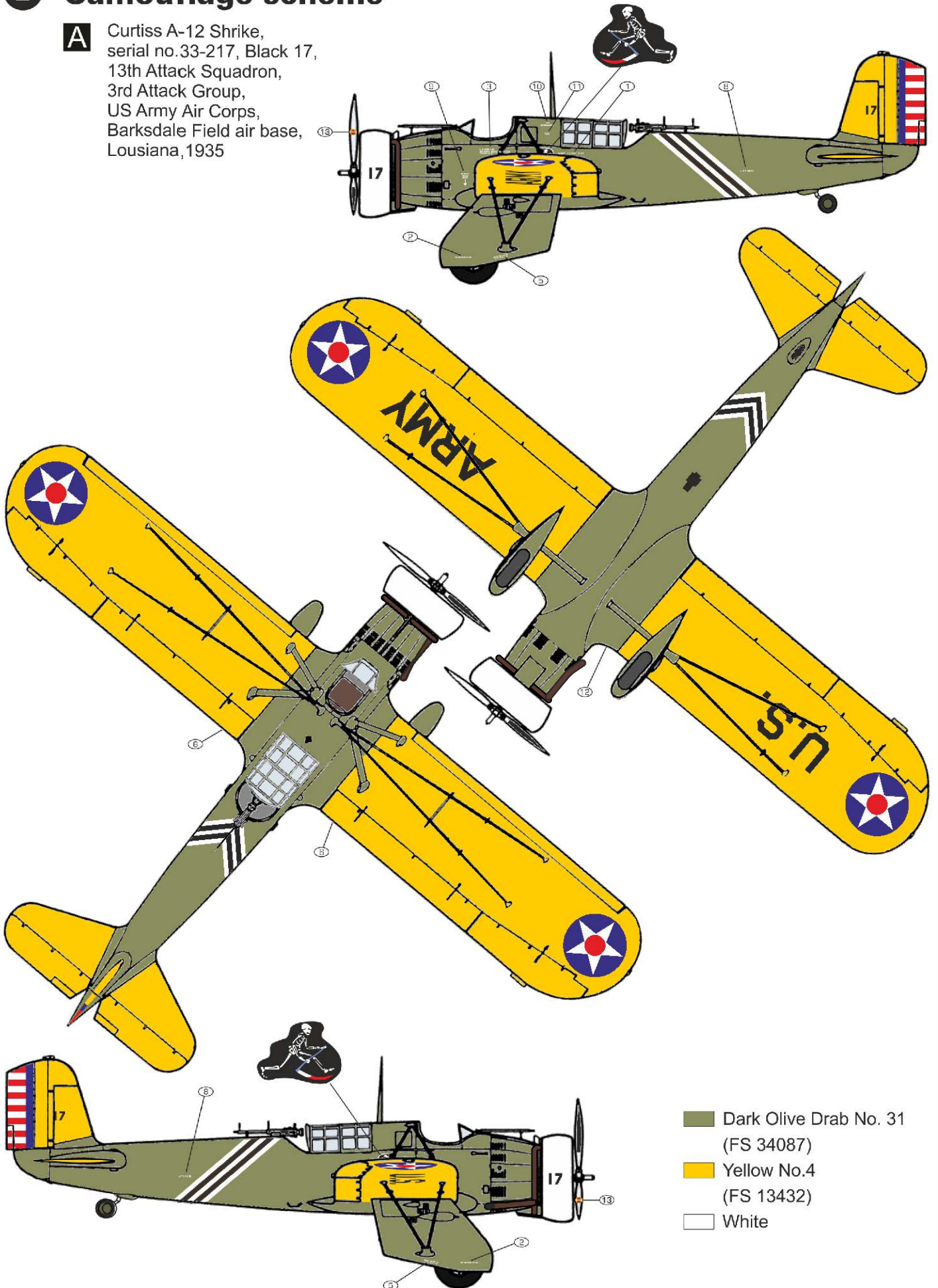

2 Camouflage scheme

B Curtiss A-12 Shrike,
 serial no.33-238,
 Black 38/7
 8th Attack Squadron,
 3rd Attack Group,
 US Army Air Corps,
 Fort Crockett airfield,
 Texas,
 Winter Manouvres,
 February 1935

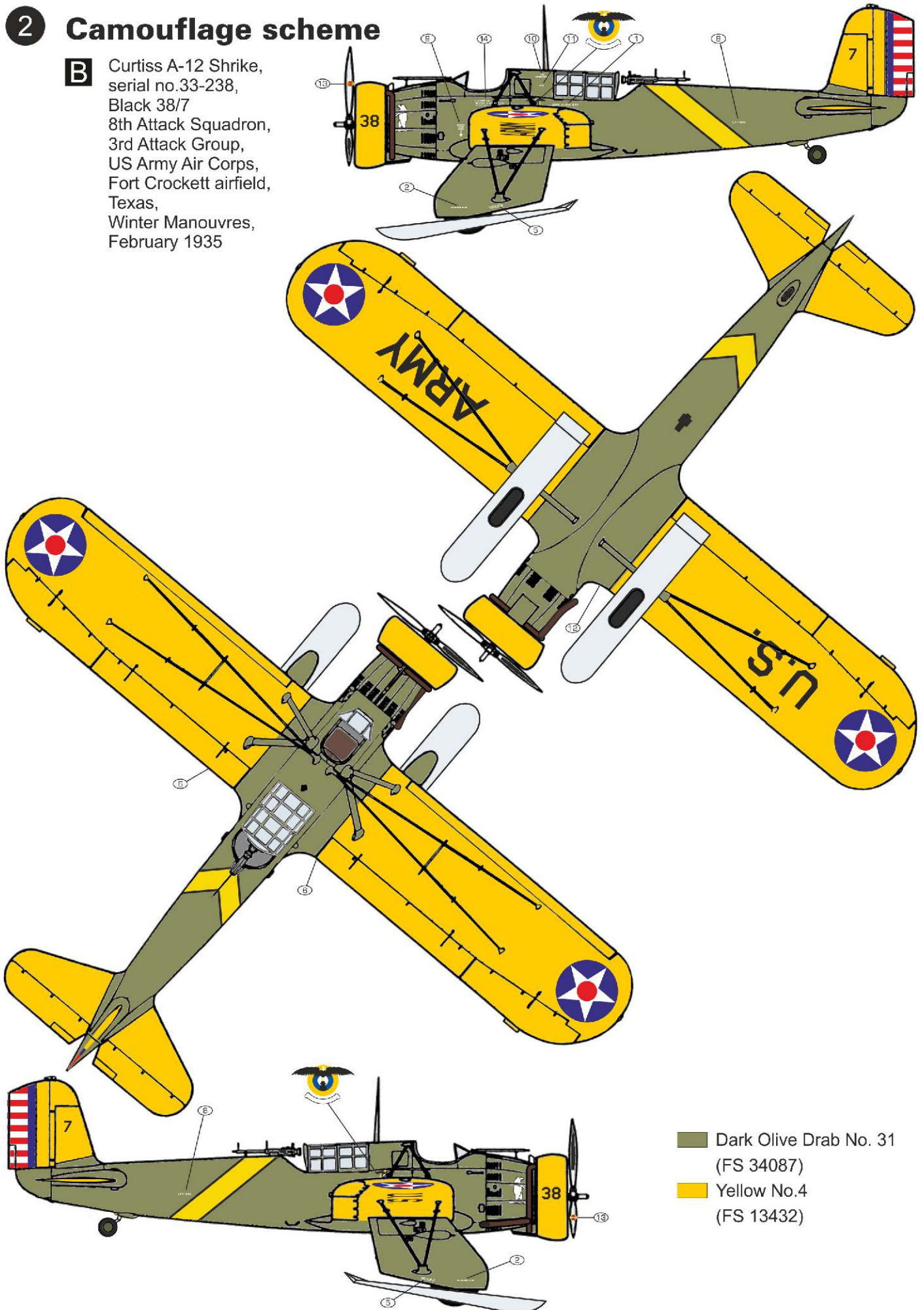

- Dark Olive Drab No. 31
(FS 34087)
- Yellow No.4
(FS 13432)

2 Camouflage scheme

C Curtiss A-12 Shrike, Black 144
 26th Attack Squadron,
 18th Pursuit Group,
 US Army Air Corps,
 Wheeler Field, Hawaii,
 1937

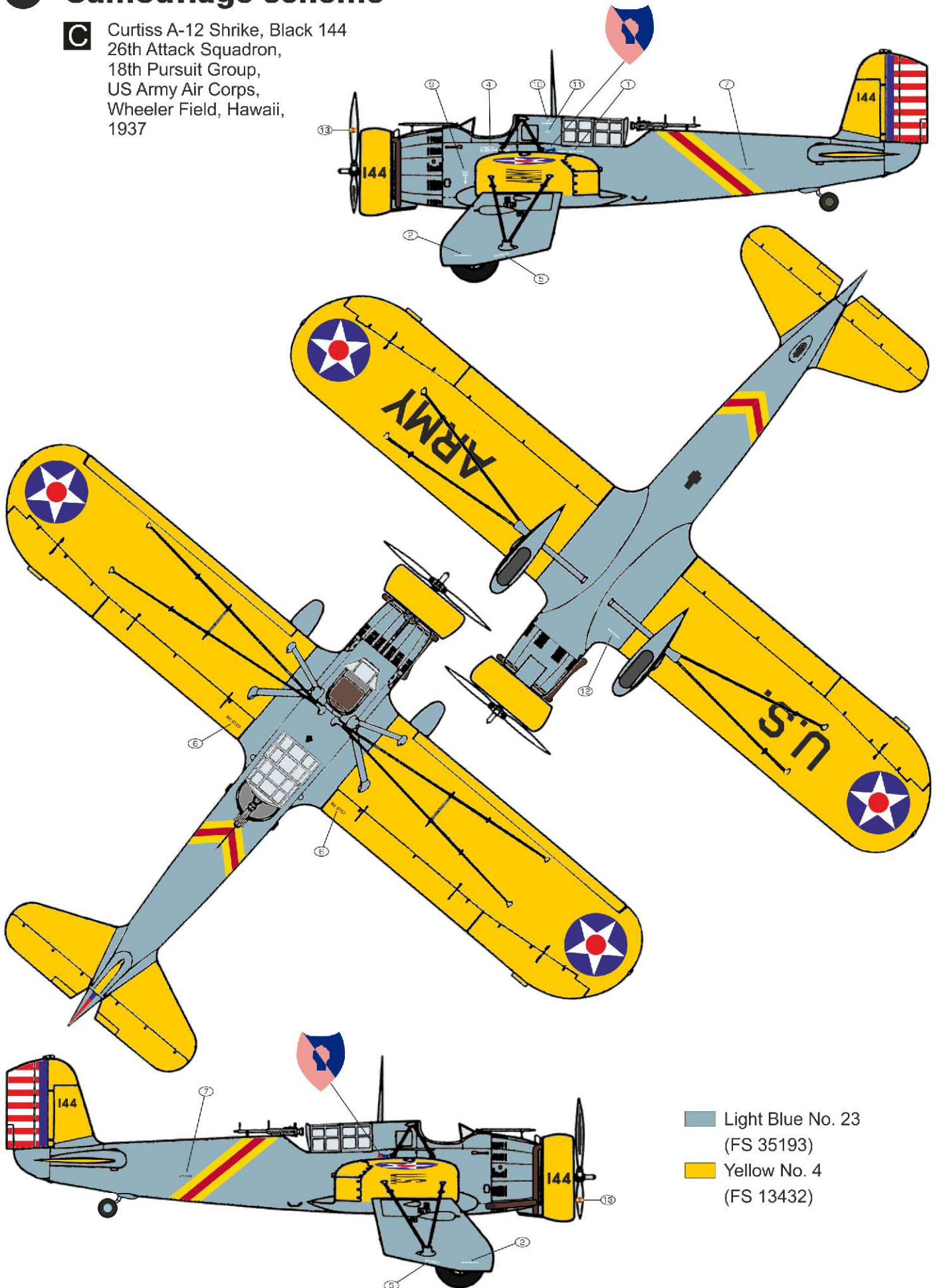

Light Blue No. 23
 (FS 35193)
 Yellow No. 4
 (FS 13432)

2 Camouflage scheme

D Curtiss A-12 Export Shrike,
Black 2608,
26th Squadron,
9th Attack Group,
Chinese Nationalist
Air Force,
Shanxi Province,
North China,
1936

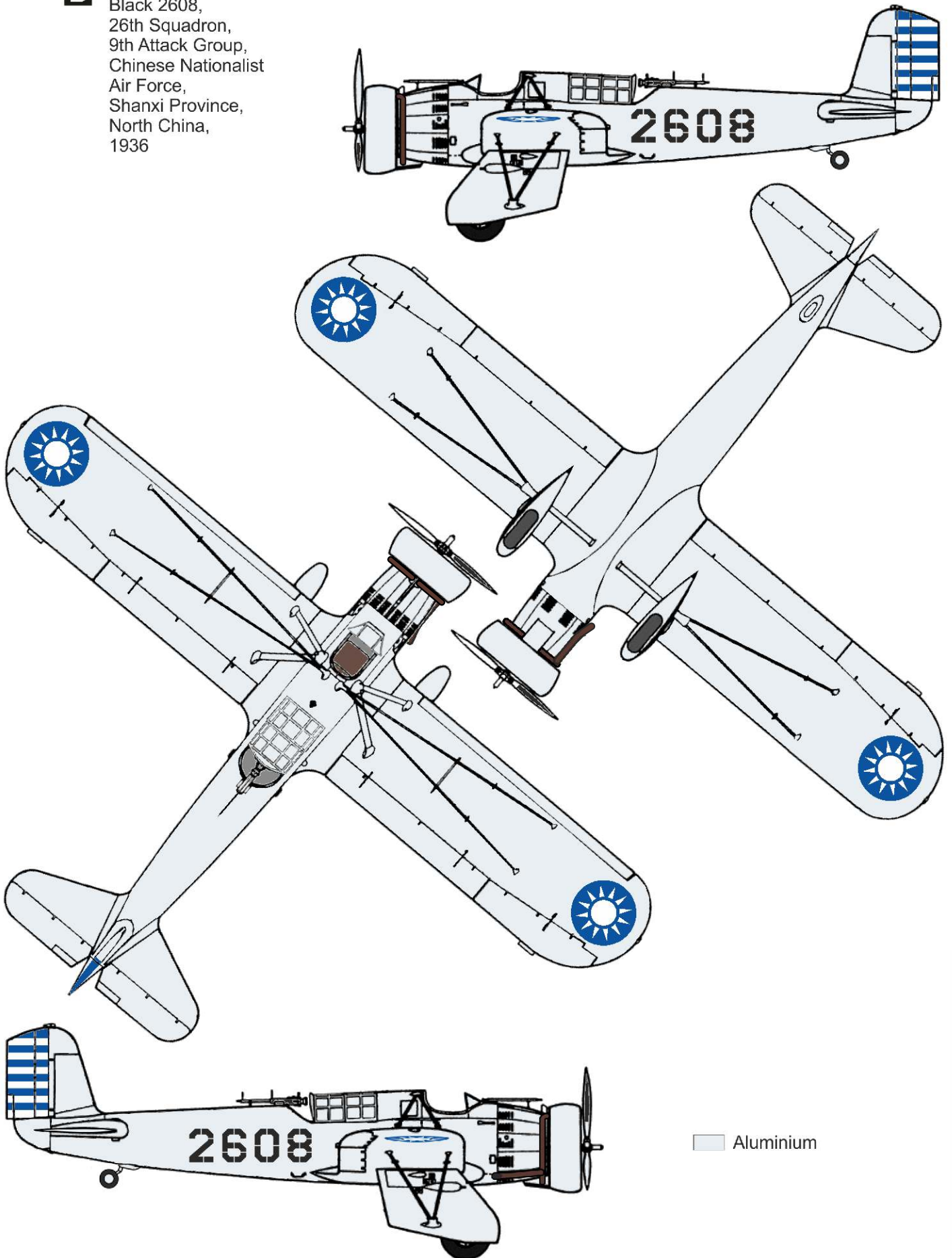

2 Camouflage scheme

E Curtiss A-12 Export Shrike,
Black 2604
26th Squadron,
9th Attack Group,
Chinese Nationalist
Air Force,
Shanxi Province,
North China,
summer 1937

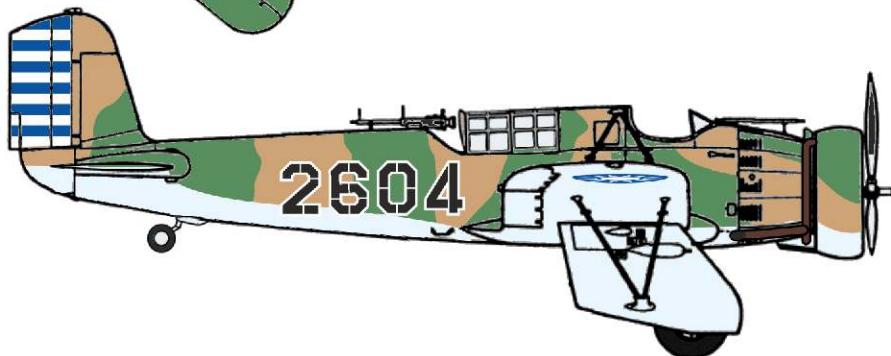
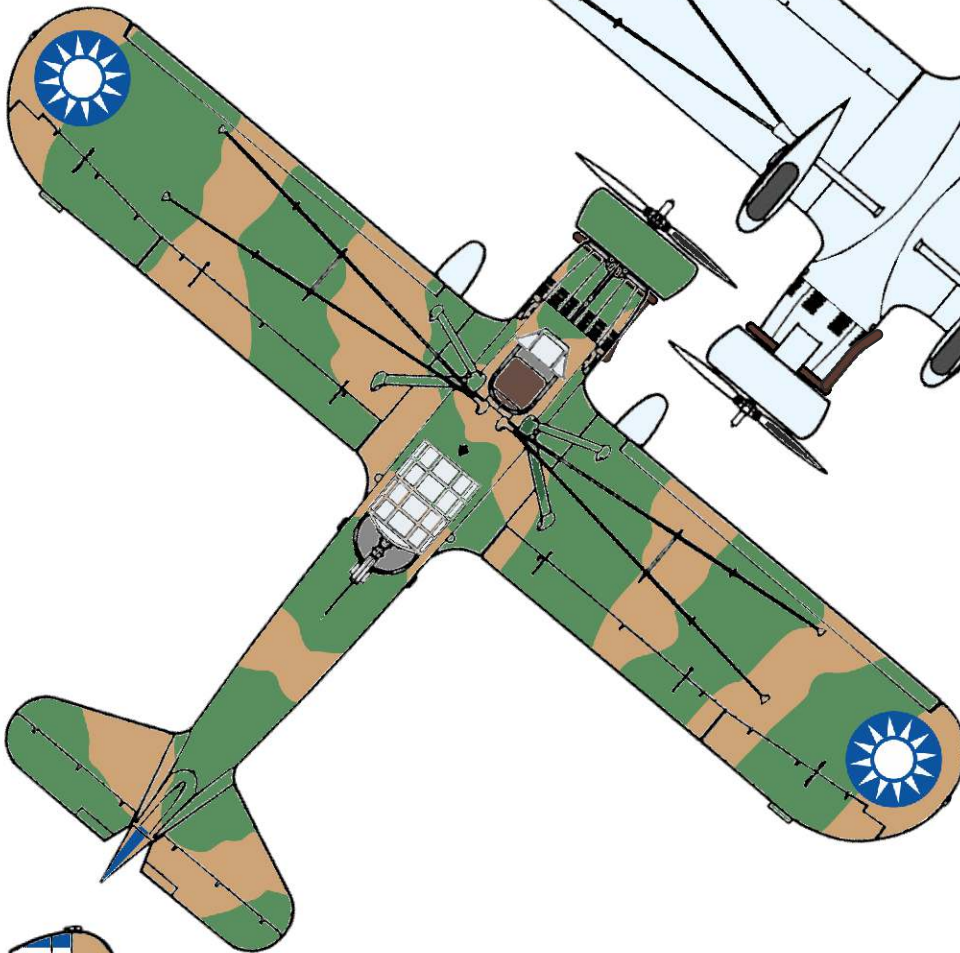
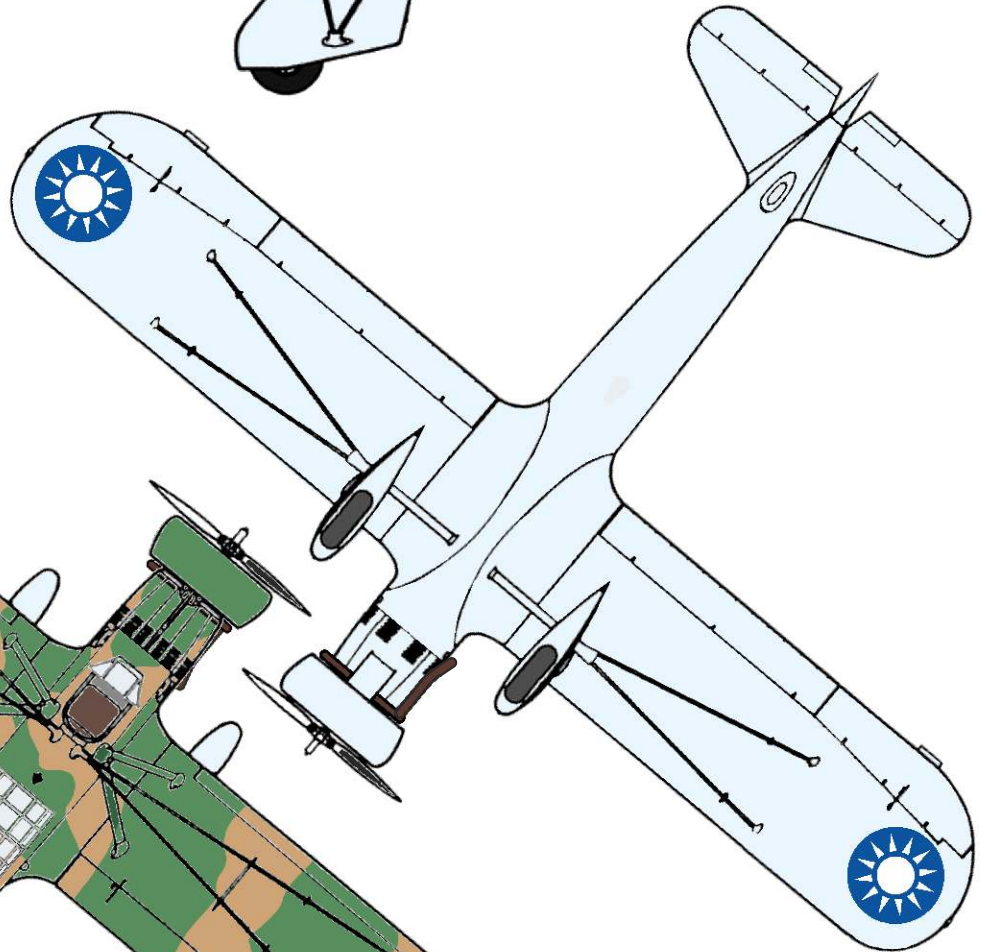
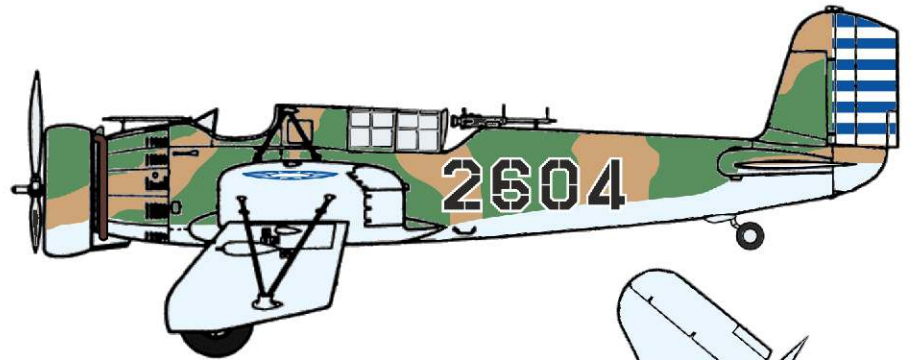

- Light Earth
(FS 33245)
- Dark Green
(FS 34058)
- Light Blue
(FS 35526)