

PHOTO-ETCHED PARTS
LI - L4

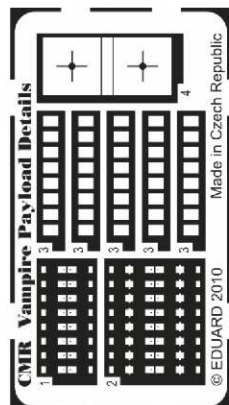
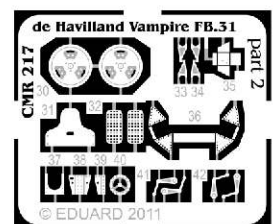
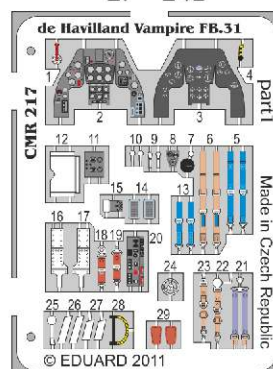

PHOTO-ETCHED PARTS
LI - L42



Note:
The Unnumbered Parts
in Light Grey Colour =
NOT REQUIRED PARTS



PLEASE NOTE:
Use this assembly diagram for:
scheme A,B,C,D ONLY

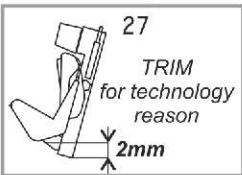
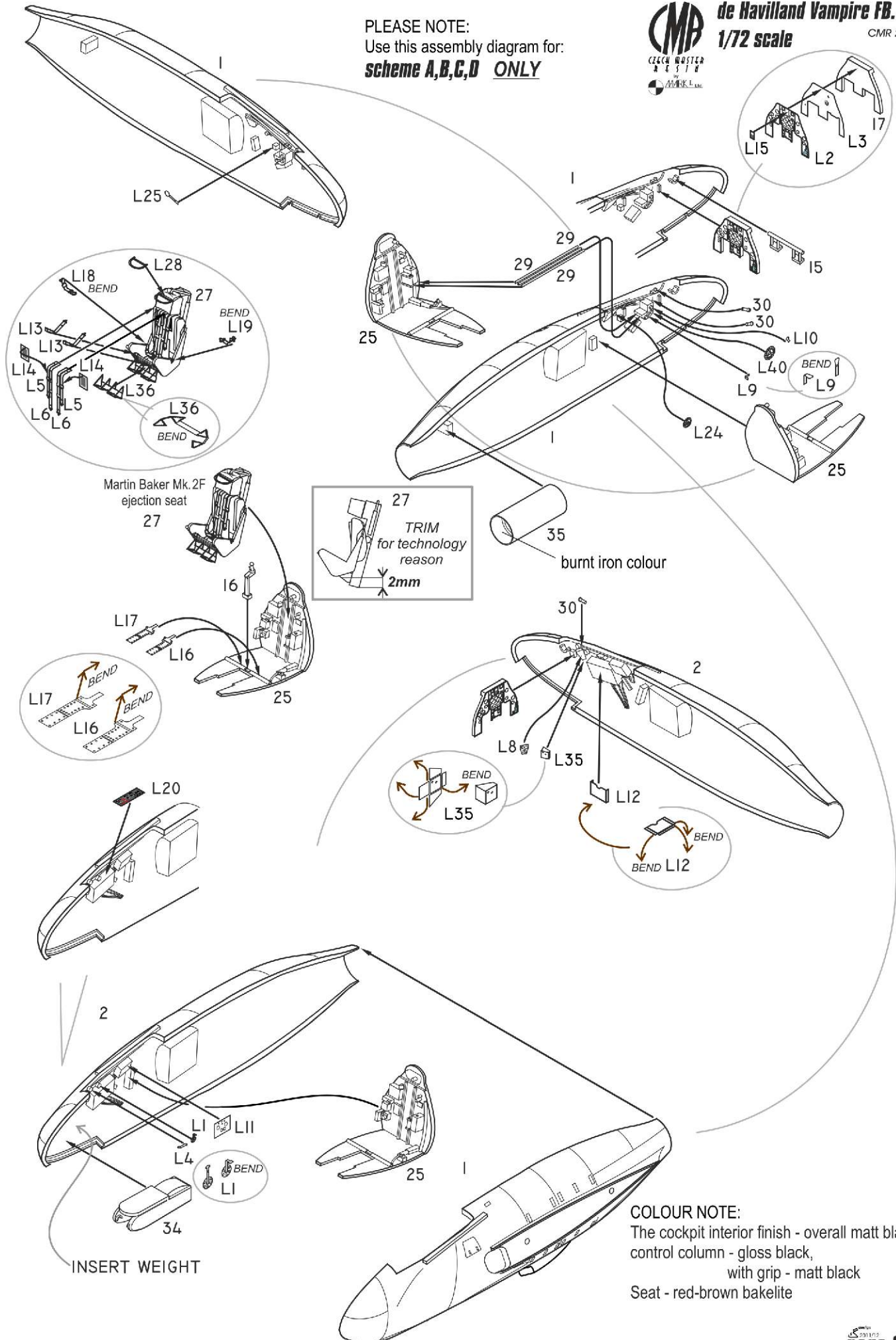

burnt iron colour

COLOUR NOTE:
The cockpit interior finish - overall matt black
control column - gloss black,
with grip - matt black
Seat - red-brown bakelite

PLEASE NOTE:
Use this assembly diagram for:
scheme E (A79-215) ONLY

COLOUR NOTE:

The cockpit interior finish - overall matt black
control column - gloss black,
with grip - matt black
Seat - red-brown bakelite

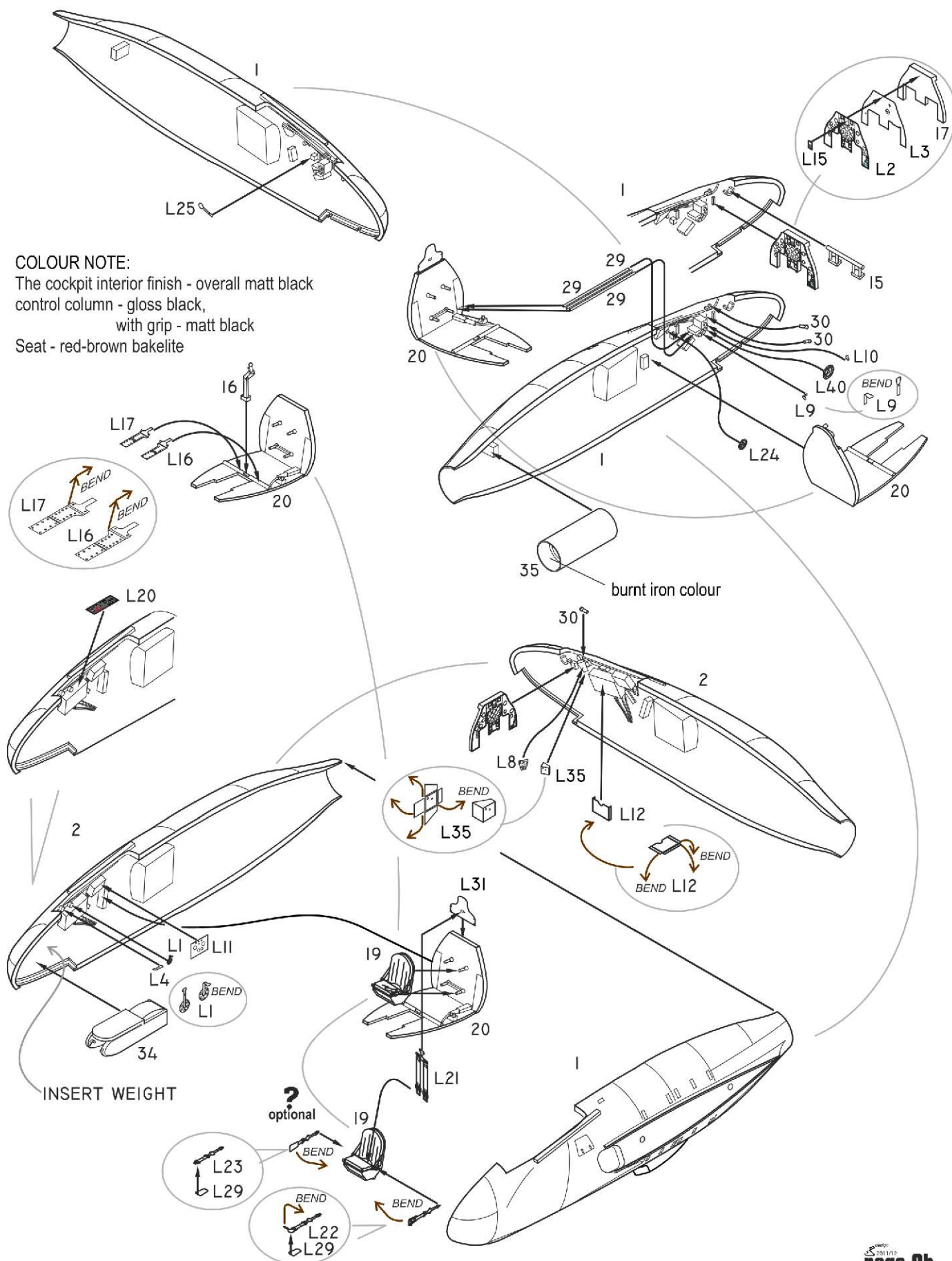

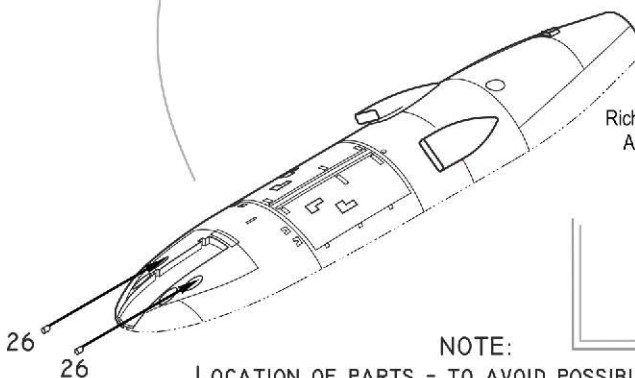
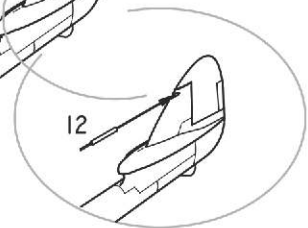
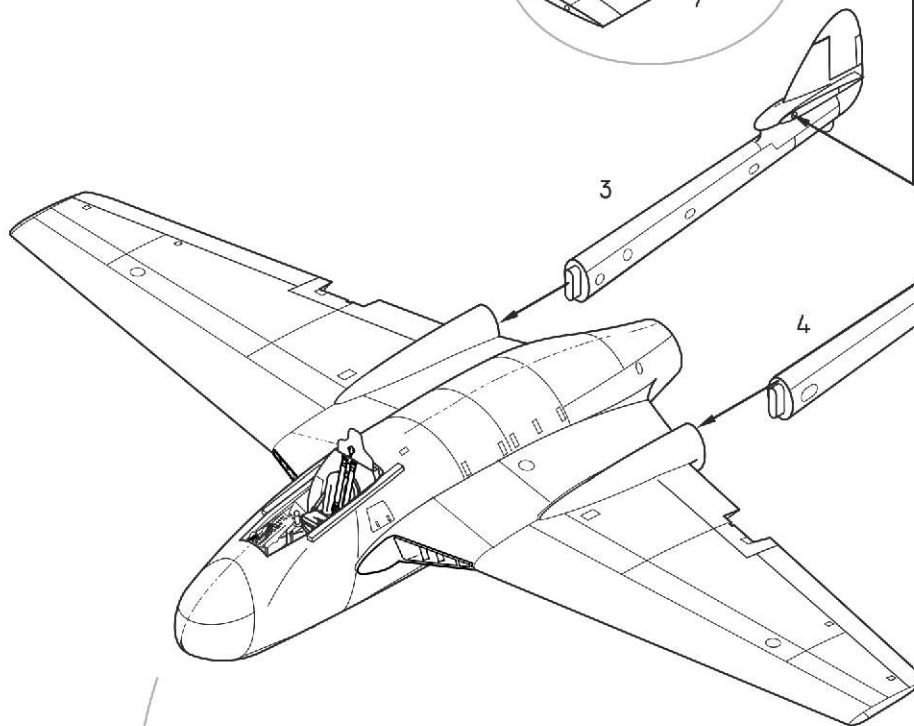
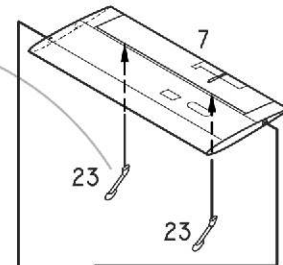
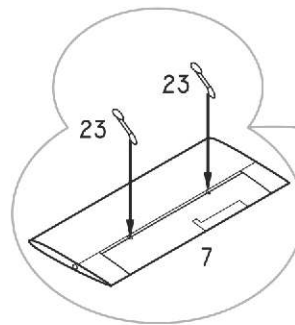
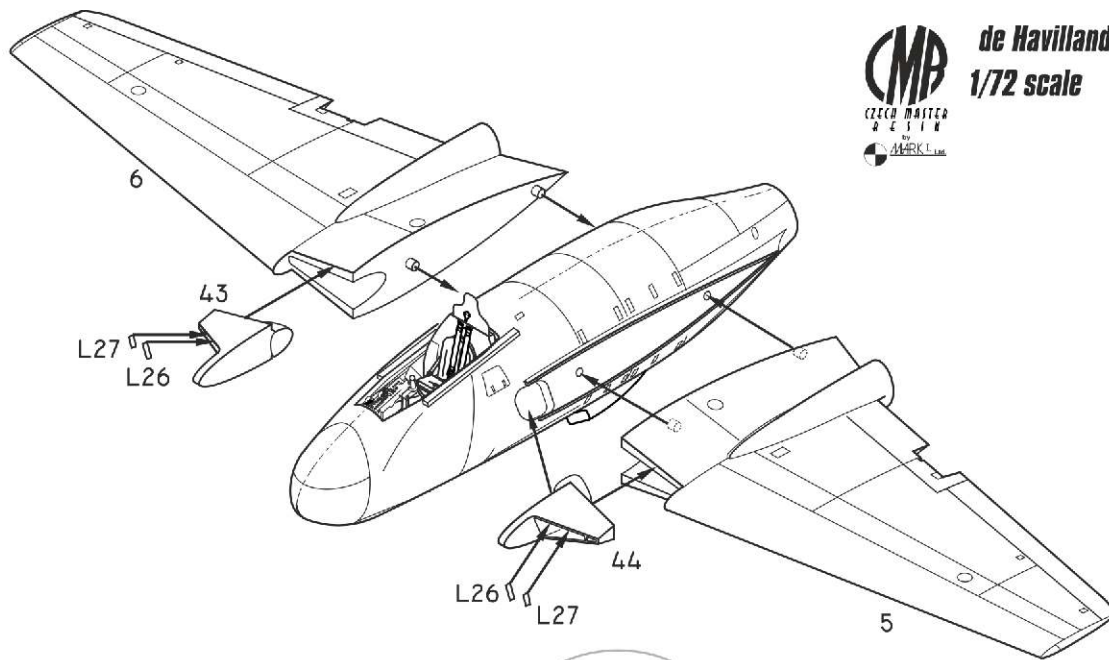

NOTE:

LOCATION OF PARTS - TO AVOID POSSIBLE DAMAGE,
SOME SMALL ITEMS SHOULD BE GLUED AT THE END OF THE BUILD

Acknowledgements

Czech Master Resin would like to take this opportunity to thank the following people for their help and invaluable research, which has enabled us to accurately reproduce this scale model of the Vampire F.30 and Vampire FB.31:
Richard Hourigan, Gary Byk, Edward Russell (Red Roo Models, Australia), and Andy White U.K.
Also, we would like to offer our special thanks to Richard Hourigan for his great involvement in the project, including full access to his archive files, without whose help this kit would have been impossible to produce to such a detailed standard.

Credit Note

Vampire, Macchi and Iroquois in Australian Service by Stewart Wilson
A View Of The De Havilland DH-100 Vampire An Illustrated Record by John Hopton
Published by The Moorabin Air Museum, Australian Aircraft Restoration Group 1997

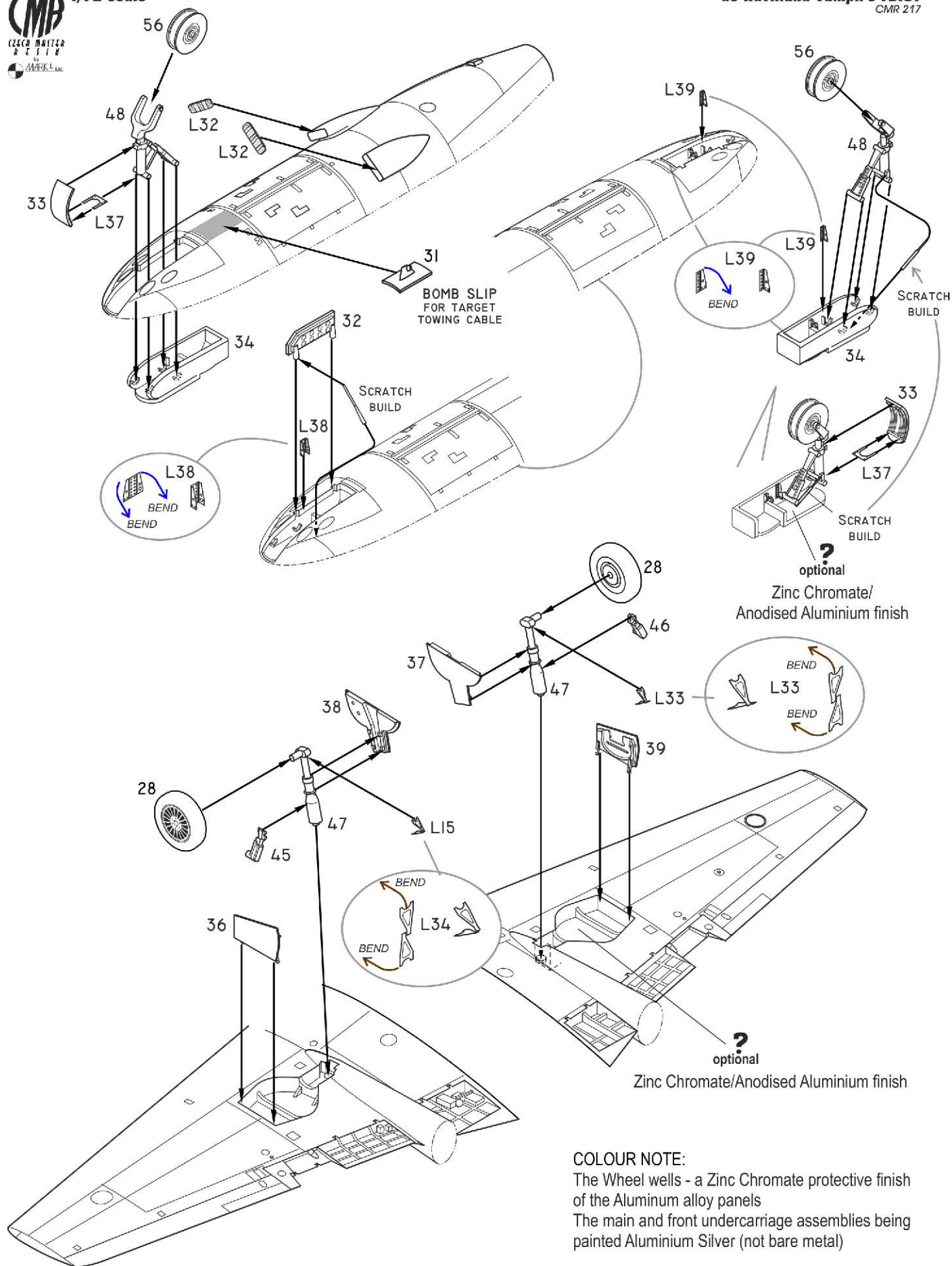

NOTE:
LOCATION OF PARTS - TO AVOID POSSIBLE DAMAGE,
SOME SMALL ITEMS SHOULD BE GLUED AT THE END OF THE BUILD

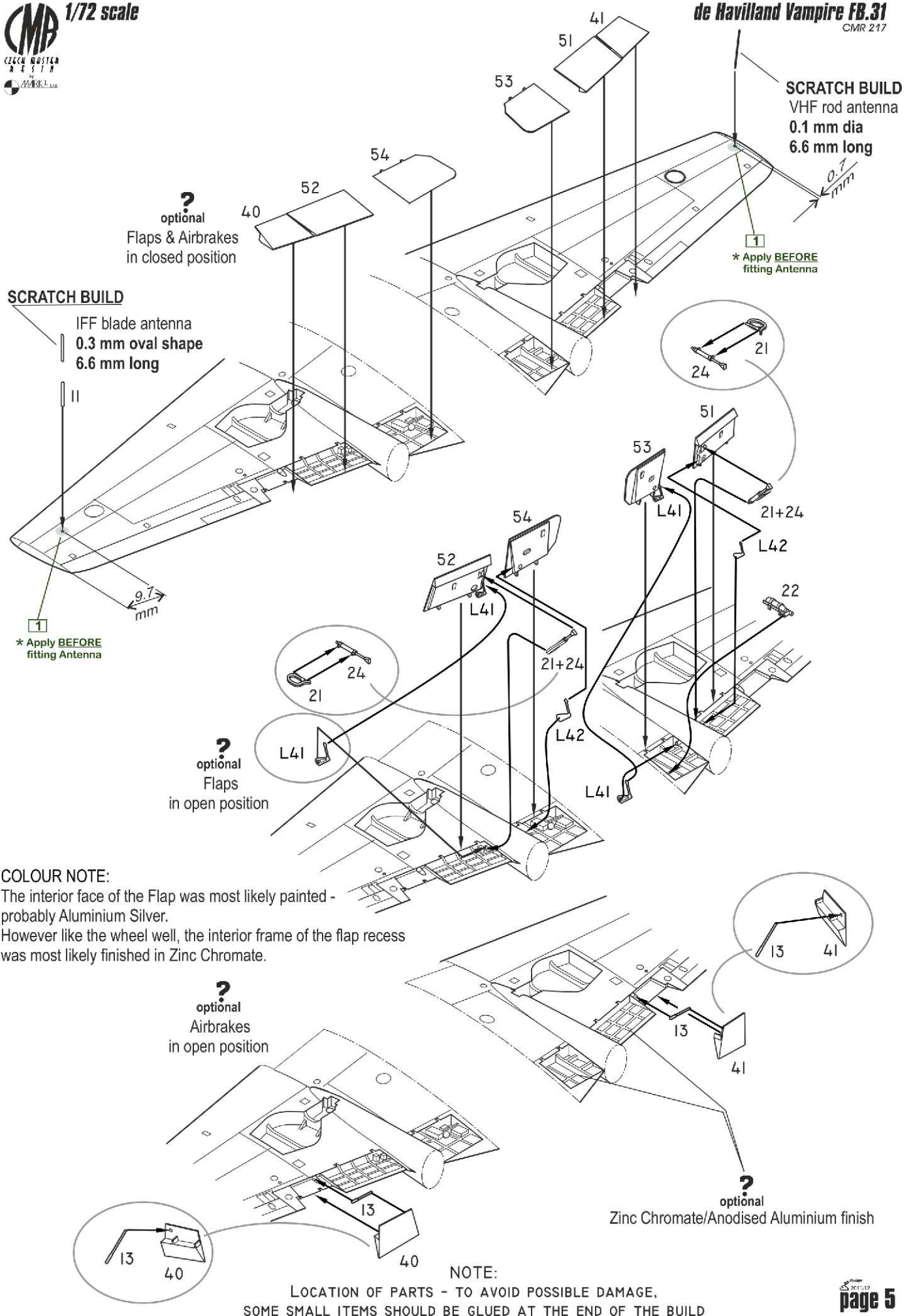

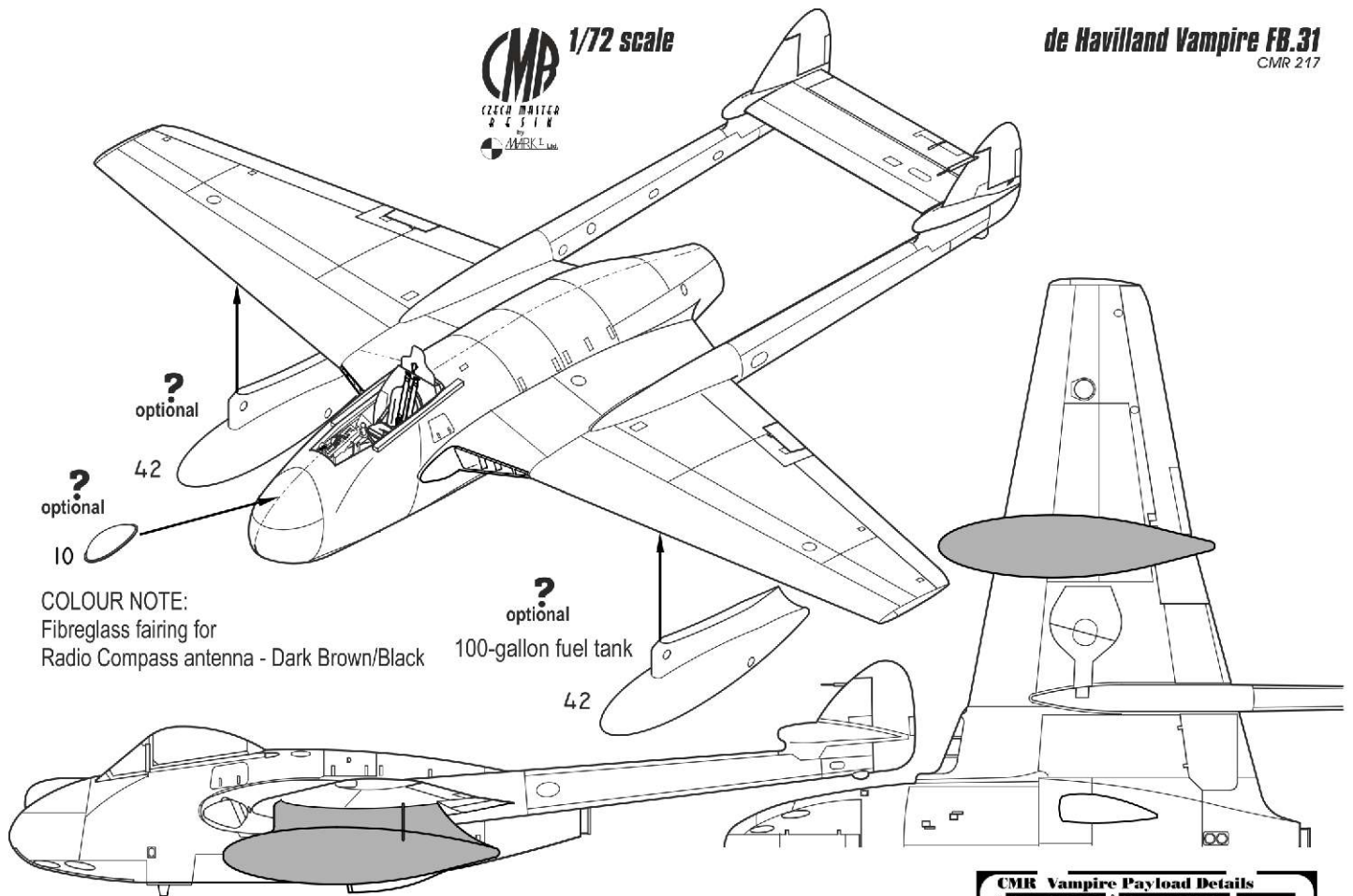

COLOUR NOTE:
Fiberglass fairing for
Radio Compass antenna - Dark Brown/Black

optional
100-gallon fuel tank

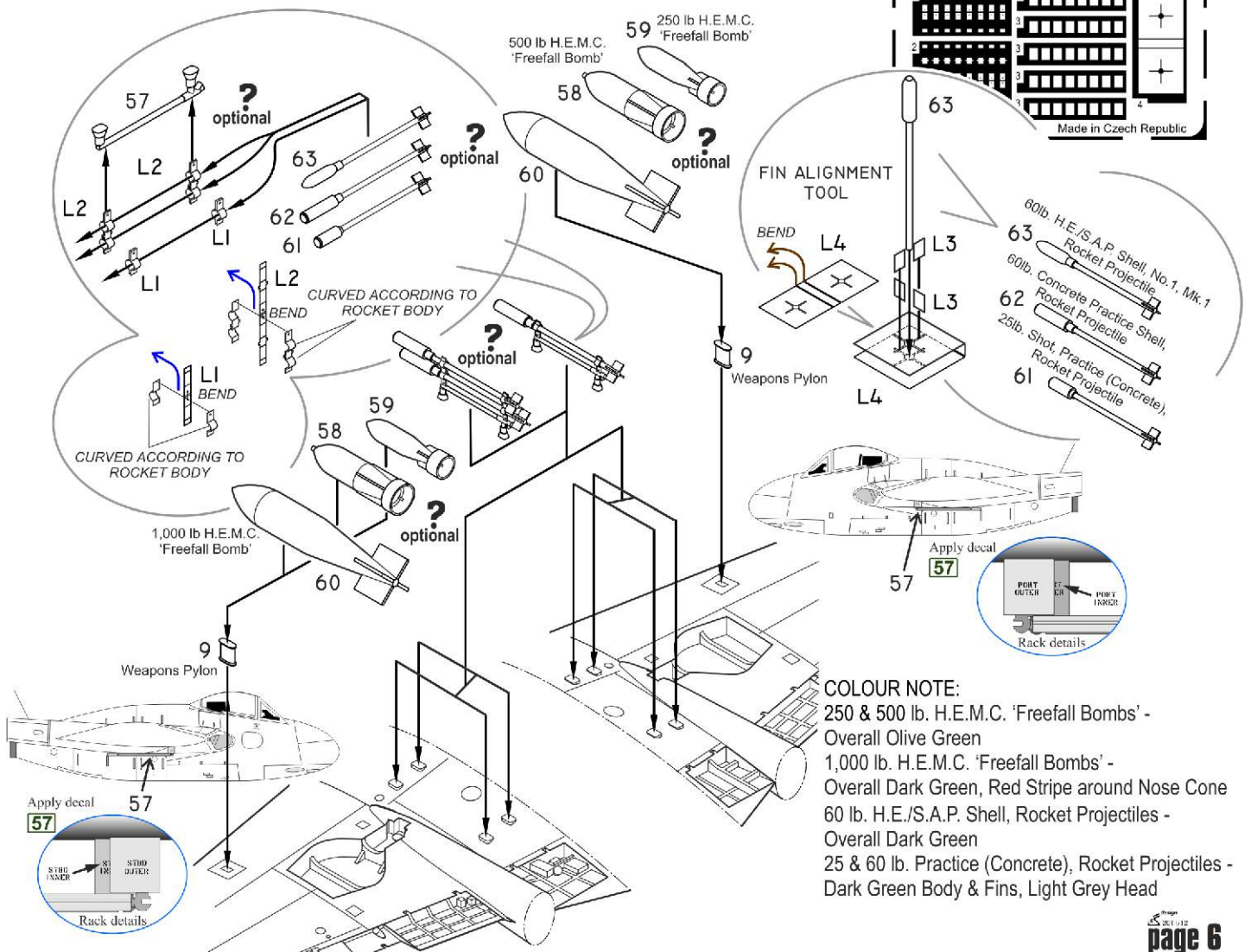
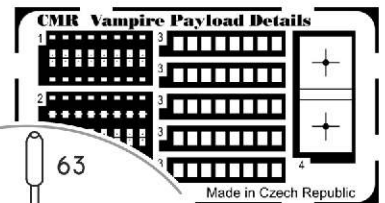

* Apply BEFORE
fitting Antenna

SCRATCH BUILD
VHF rod antenna
0.1 mm dia
6.6 mm long

8
CLEAR PART

Scratch Build
CLEAR PLATE
1.5x1.5 mm

Scratch Build
CLEAR PLATE
0.8x1.0 mm

18

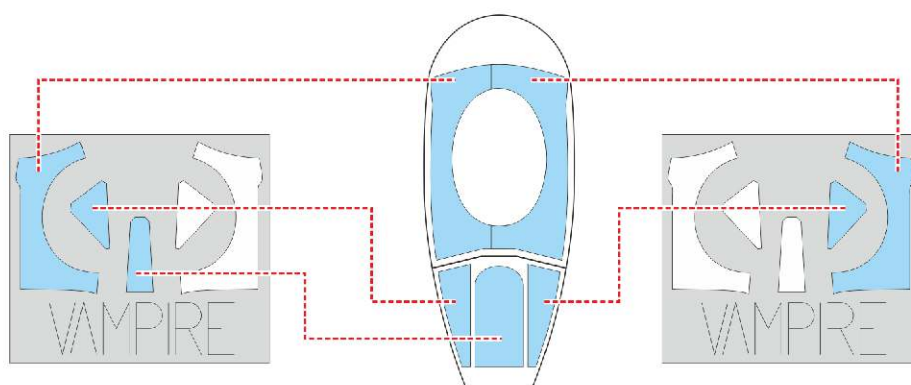
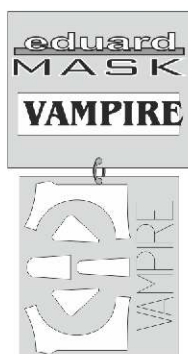
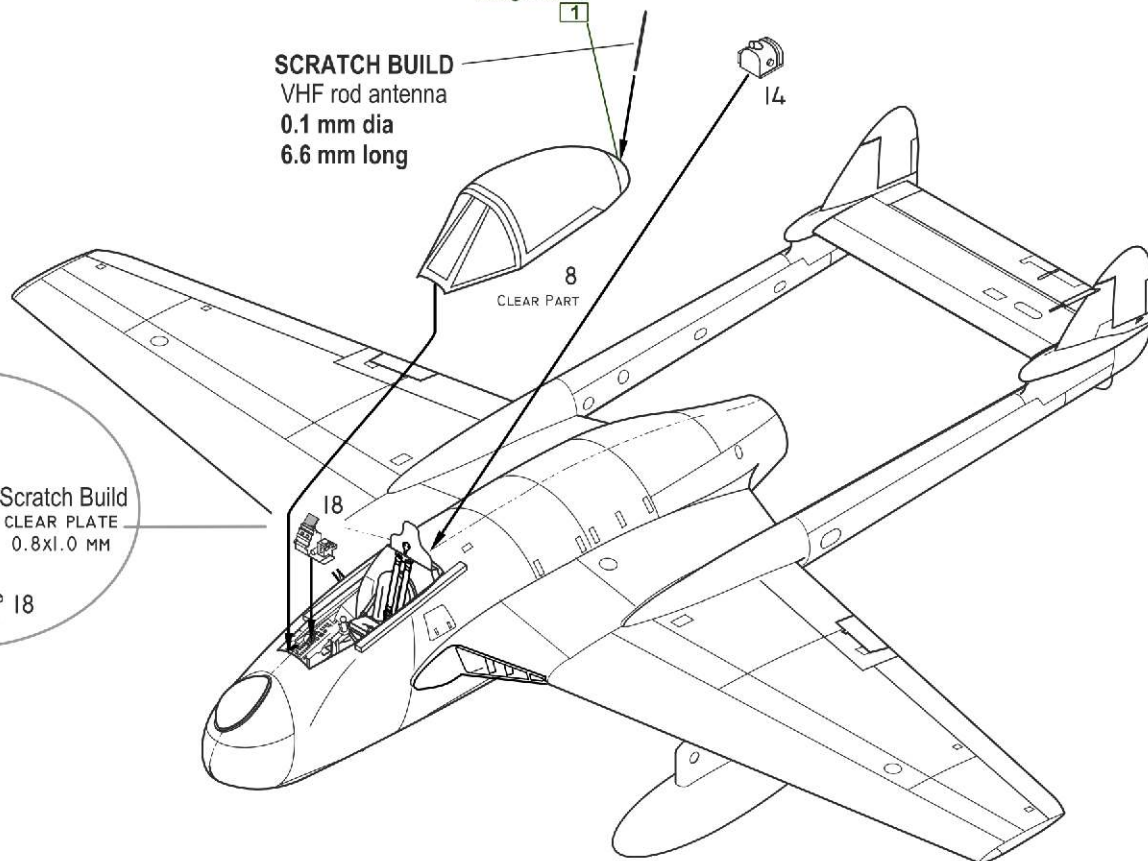

LIQUID MASK ■

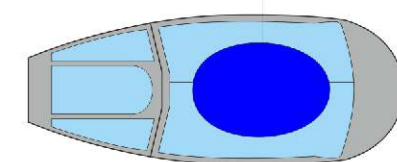

8
CLEAR PART

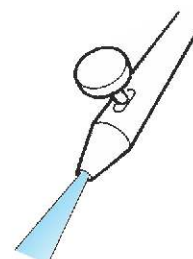

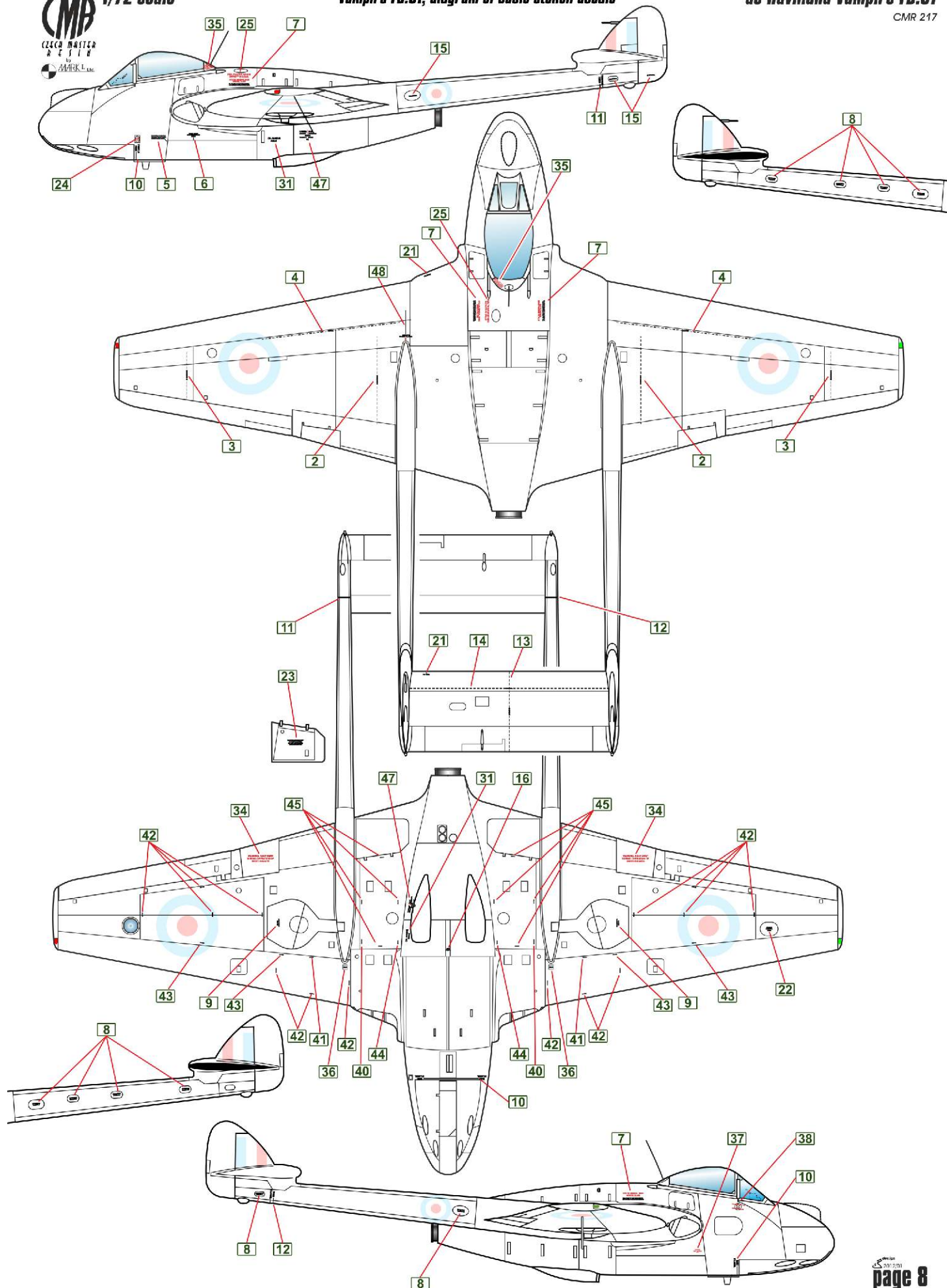



1/72 scale

CMR 217

de Havilland Vampire FB.31

scheme A Vampire FB.31, A79-111, RAAF,
No.2 O.T.U. 'Red Devils' Aerobatic Team,
Williamtown N.S.W., circa 1958.

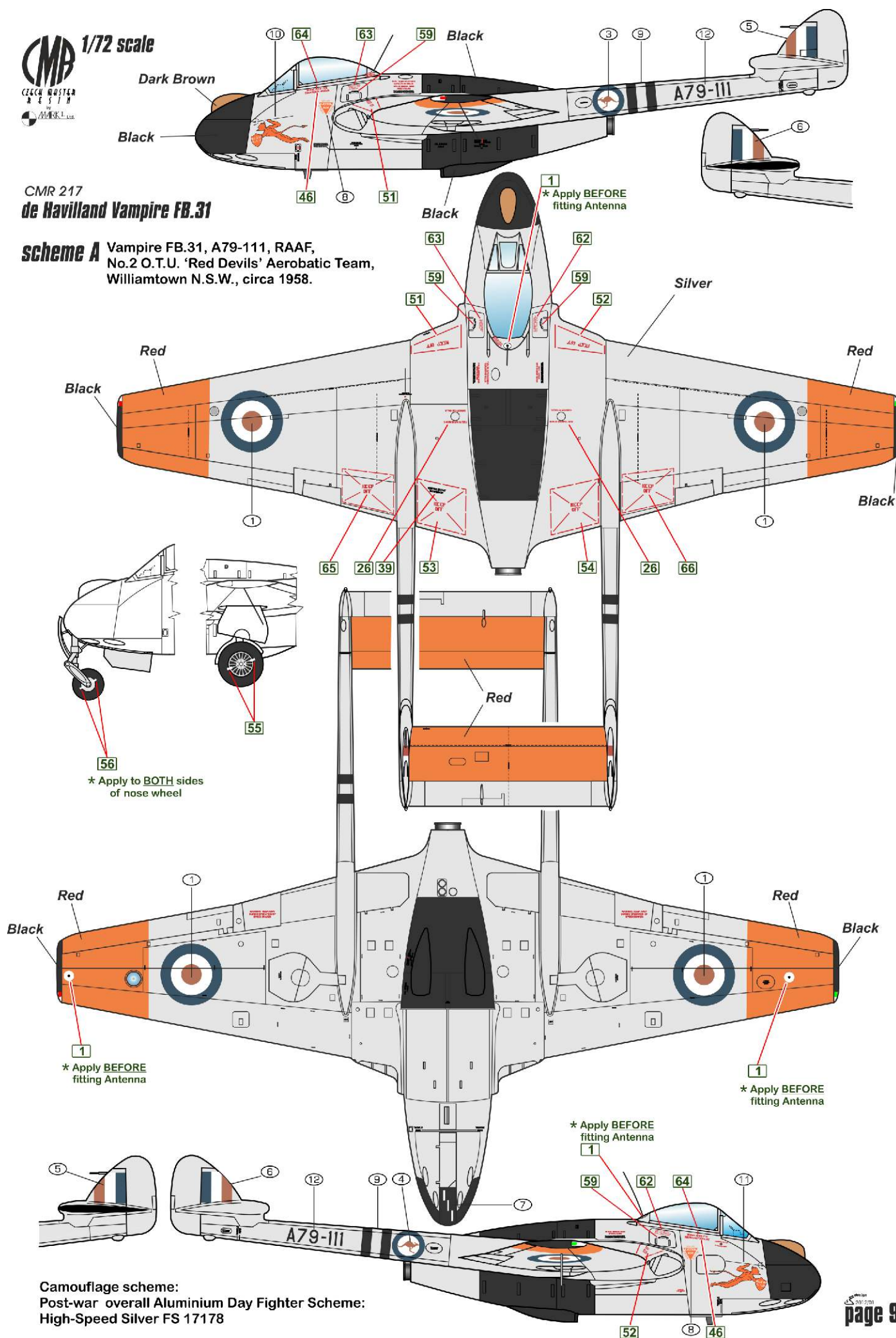

Camouflage scheme:
Post-war overall Aluminium Day Fighter Scheme:
High-Speed Silver FS 17178

CMR 217
de Havilland Vampire FB.31

scheme B Vampire FB.31, A79-422, RAAF,
No.21 Squadron,
Laverton, Victoria, 1961.

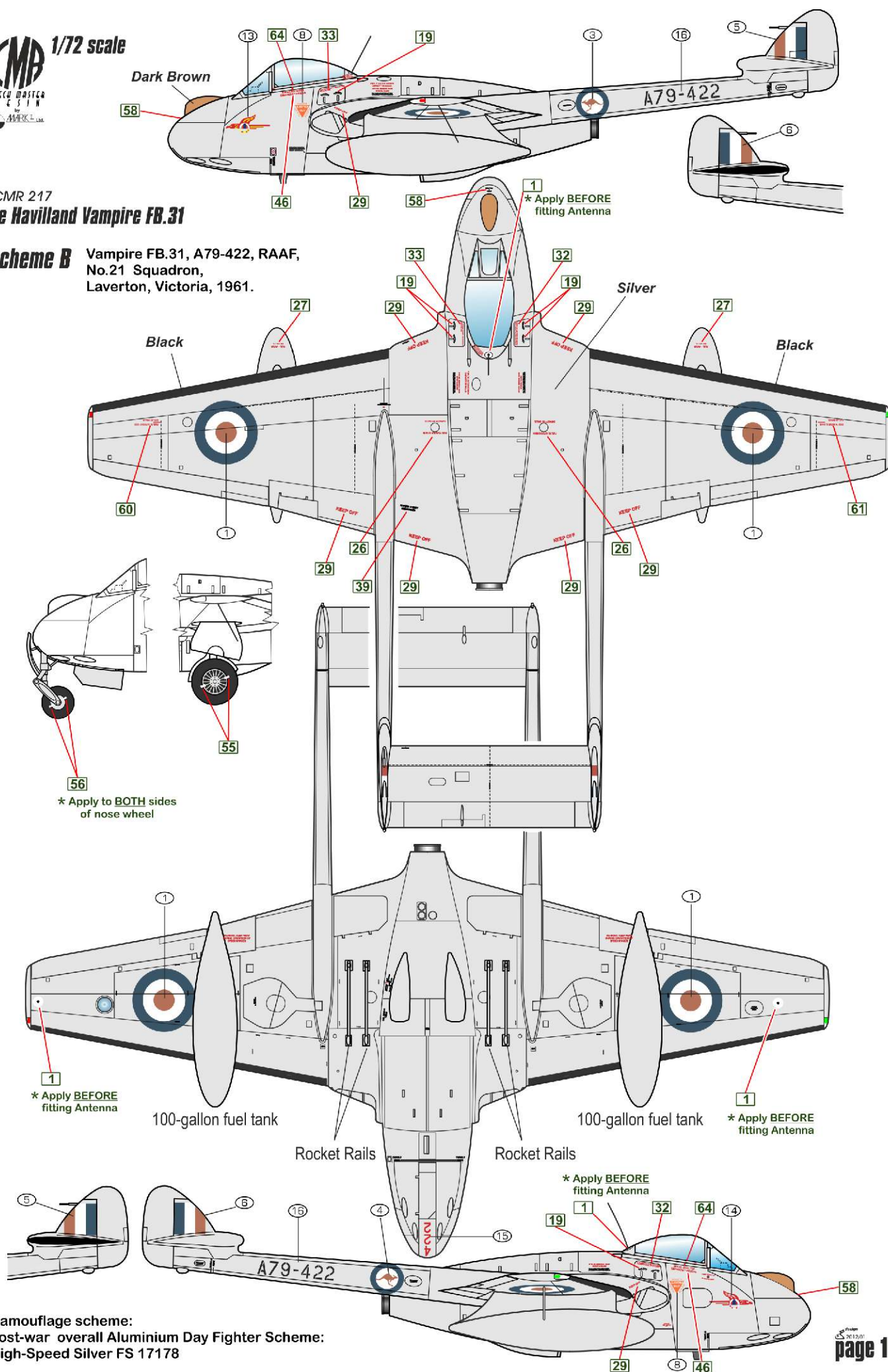

Camouflage scheme:
Post-war overall Aluminium Day Fighter Scheme:
High-Speed Silver FS 17178

CMR 217
de Havilland Vampire FB.31

scheme C Vampire FB.31, A79-550, RAAF,
Date and Place unknown.

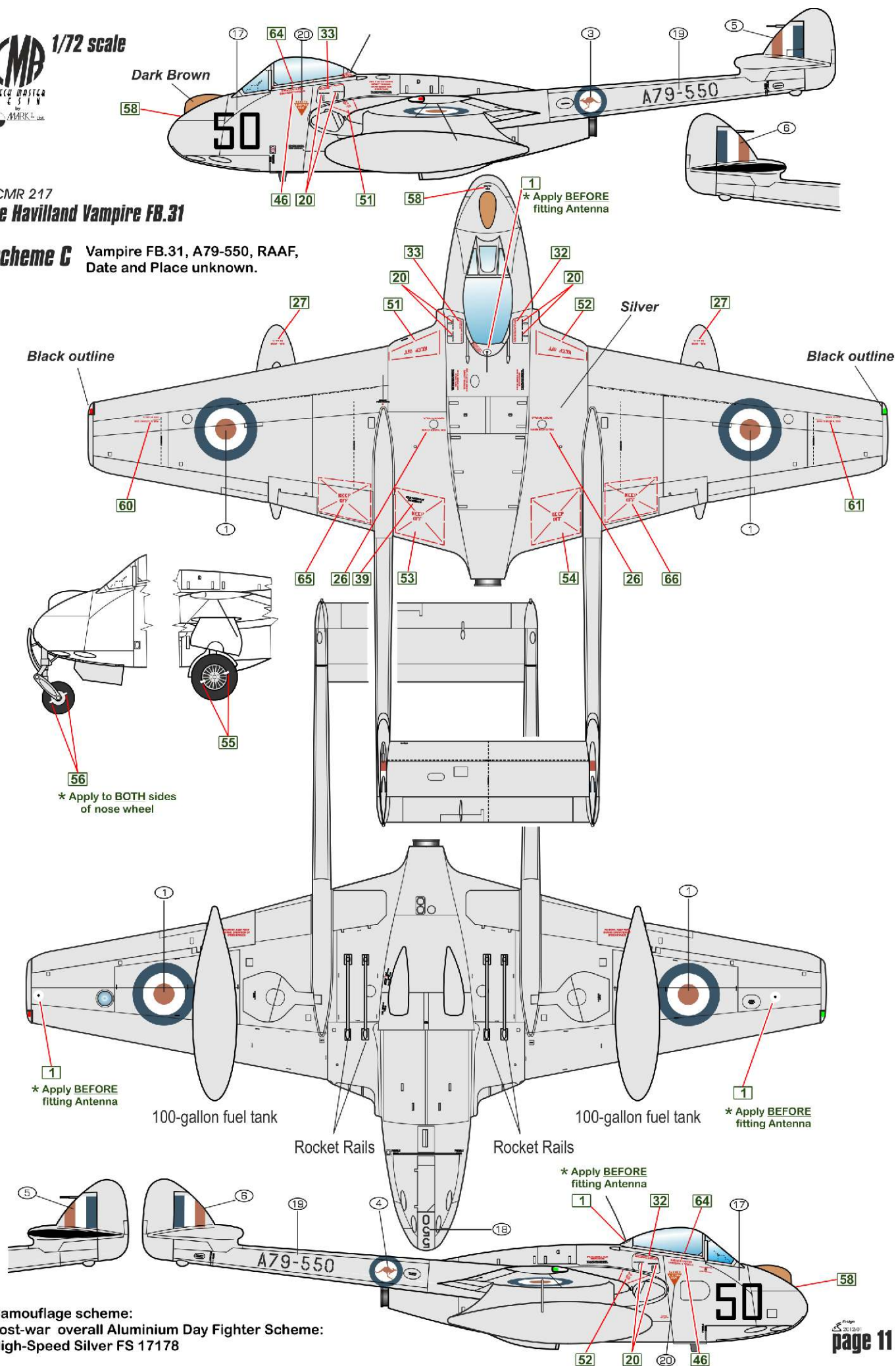

CMR 217

de Havilland Vampire FB.31

Scheme D

Vampire FB.31, A79 915, RAAF,
No.21 Squadron,
Laverton, Victoria, September 1959.

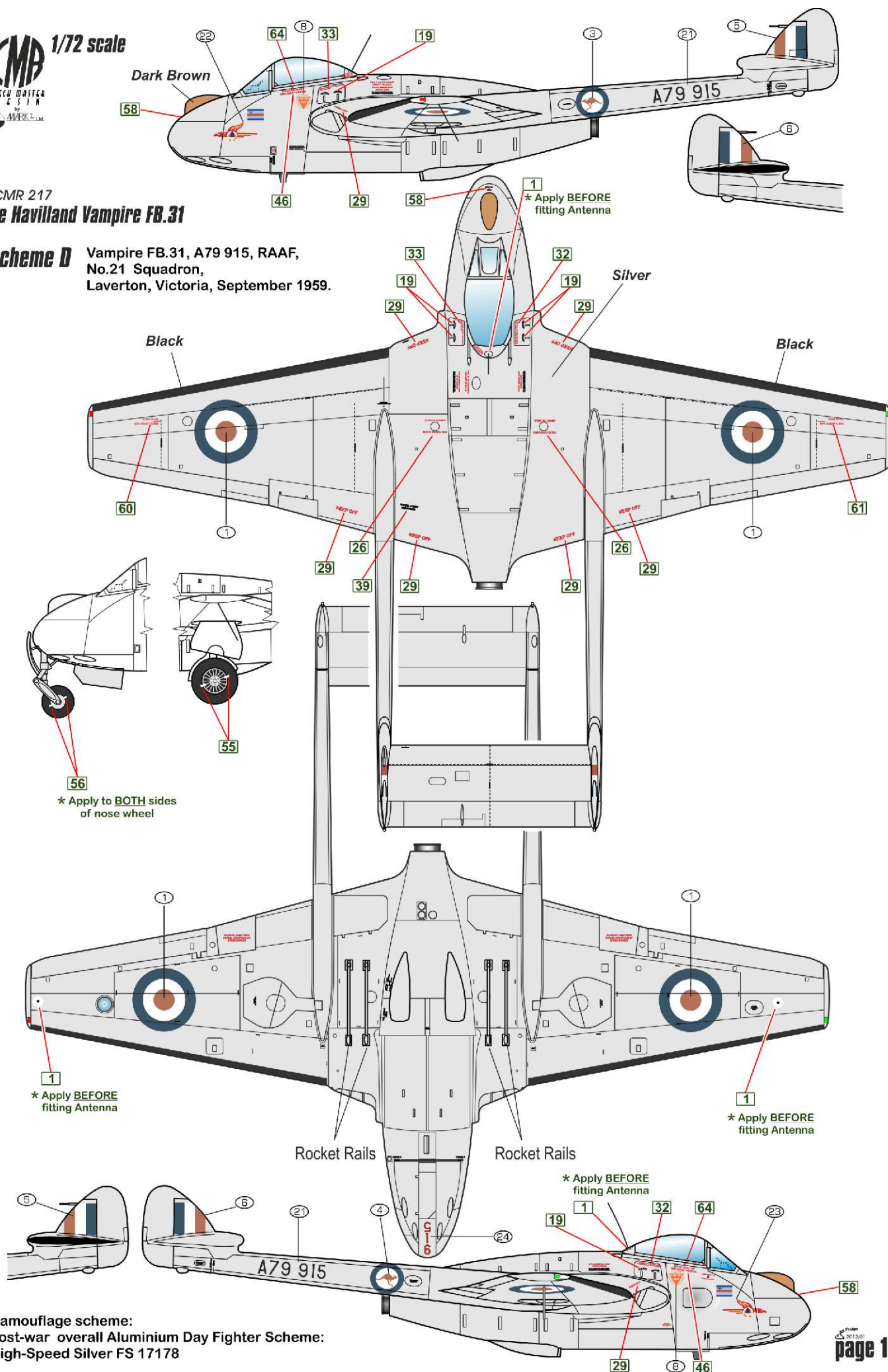

Camouflage scheme:
Post-war overall Aluminium Day Fighter Scheme:
High-Speed Silver FS 17178

CMR 217
de Havilland Vampire FB.31

scheme E Vampire FB.31, A79-215, RAAF,
No.21 Squadron, 1957.

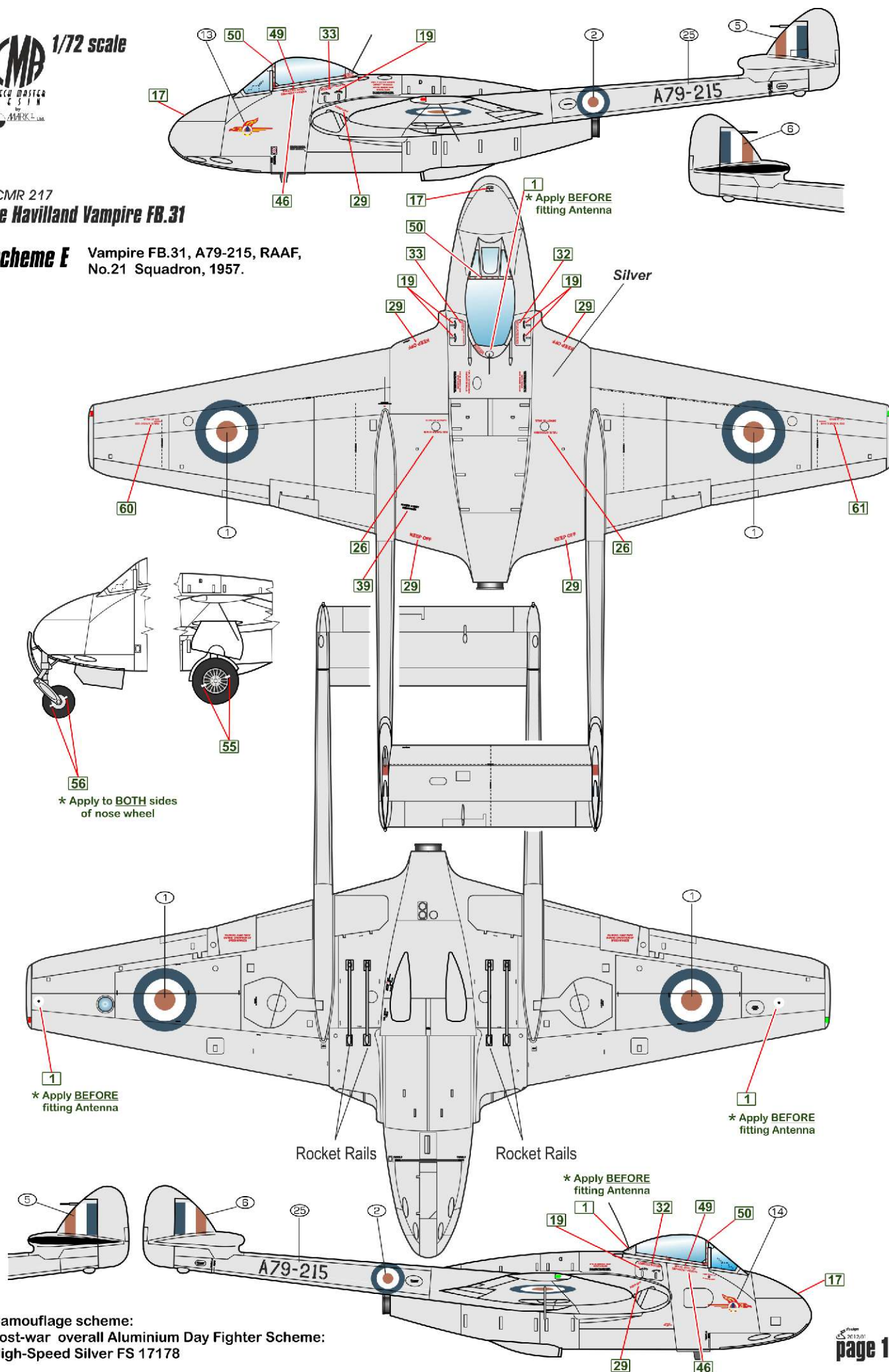

Camouflage scheme:
Post-war overall Aluminium Day Fighter Scheme:
High-Speed Silver FS 17178